



Eclipse Architectural®
Exterior Folding Door Systems

Beautiful doors for beautiful spaces

E3™ System

Hardware, Track, Sill System & Weathersealing for Exterior Folding Doors & Windows

Specification & Fabrication Catalogue

DS Group®

www.theDSgroup.com

Tomorrow's Innovative Solutions for Today's Doors & Windows

The DS Group Of Companies : Draftseal®, Kristrack®, Eclipse Architectural® & DSD Hardware

E3 Hardware, Track, Sill System & Weathersealing for Exterior Folding Doors & Windows

In a single direction

maximum panel weight : 220 lbs (100 kg) each panel
 maximum panel width : 39" (990mm)
 maximum panel height : 118" (2997mm)
 maximum number of panels : 8 each way

- panel thickness : 1-3/4" (44.5mm) or 2-1/4" (57mm) when using E3™ sill system
- panel thickness : 1-3/8" (34.9mm) to 3" (76.2mm) when using floor channel

NOTE: When using maximum panel width & height 39" (990mm) x 118" (2997mm) panel may exceed maximum panel weight of 220 lbs (100 kg). Calculated weight check should be done.

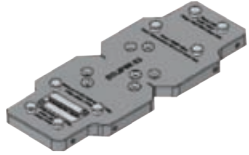

KTE3DJ
Eclipse E3 Drilling Jig

See E3 Drilling Jig instruction sheet on www.eclipsearchitectural.com (under Products > E3 folding door systems)

Parts Selection

Eclipse E3 is specified with 5 separate groups : track, sill, weathersealing, flushbolts and hardware. Components are required from all 5 groups to build an Eclipse folding door system.

Top Track

With flushbolt pin channel

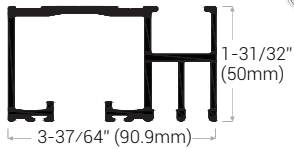

KT75C clear anodized
KT75D bronze anodized
 Lengths available : 111", 147", 183", 222", 294"
 (2.81m, 3.73m, 4.64m, 5.63m, 7.46m)

Top Track, extruded aluminum (OPTIONAL)

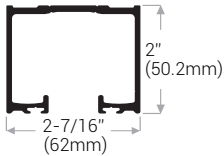

KT70C clear anodized.
KT70D bronze anodized.
 Lengths available : 111", 147", 183", 222", 294"
 (2.81m, 3.73m, 4.64m, 5.63m, 7.46m)

Sill System

KT768GASKET
 sill to jamb assembly gasket

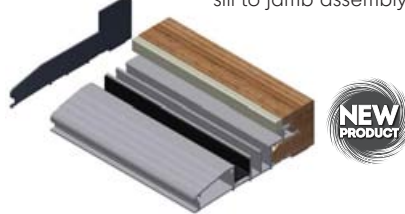

Fir top water return sill, extruded aluminum clear or bronze anodized.

KT795 8" wide (203mm) for 1-3/4" (44.5mm) door.
KT797 8" wide (203mm) for 2-1/4" (57mm) door.
KT775 6-9/16" wide (167mm) for 1-3/4" (44.5mm) door.
KT777 6-9/16" wide (167mm) for 2-1/4" (57mm) door.

Lengths available : 111", 147", 183", 222", 294" (2.81m, 3.73m, 4.64m, 5.63m, 7.46m). Order flushbolt cups and sill assembly end gaskets separately.



KT795COVERBLVE
 PVC insert, black. Snap in cover for flushbolt channels for the new Eclipse sill & top track. Fits into sills above.

Floor Channel

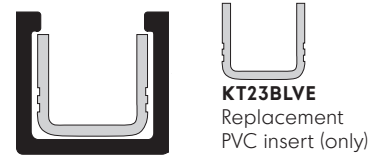

KT23CV floor channel, aluminum clear anodized with PVC insert, black
KT23DV floor channel, bronze anodized with PVC insert, black.
 Lengths available : 111", 147", 183", 222", 294"
 (2.81m, 3.73m, 4.64m, 5.63m, 7.46m)



KT750GASKET
 included with KT749, fits under rim of cup

KT749
 Flushbolt cup, satin or bronze

Flushbolt cup used with floor channel and ADA sill

Weatherseals & Astragal



KT427 Weatherseal for sill, jamb and header. Black, brown or white



KT426 Weatherseal for between doors. Black, brown or white



DS369A7145B Aluminum T-slot extrusion with black pile insert, for top and bottom of doors



KT428B Black weatherseal for between doors, use on clad doors where kerf slot is not possible
KT428W White

KT190 Fir astragal, may be stained or painted



KT427
 Kerf seal



DSP108-35BL
 Pile weatherseal for door with astragal, 5/16" (8mm) pile height, black



DS7145-270B
 Pile weatherseal for KT70 & KT75 top track, black

Flushbolts or Twinpoint

FOR OUTSWING & INSWING DOORS

4 lengths available :



7-7/8" (200mm)
 15-3/4" (400mm)
 23-5/8" (600mm)
 39-3/8" (1000mm)

DBOT Style 1" (25.4mm) throw length regardless of bolt length.

Finishes available : brushed aluminum or bronze powder coat.



Hardware

2 stock finishes available : Stainless steel & pvd bronze

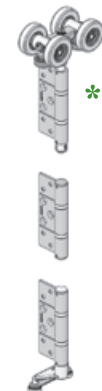

* PVD brass (TG) finish is custom order, call for manufacturing time.

NO SCALE

INDEX

KT190C84B	2, 33
KT190C84BL	2, 33
KT190C84W	2, 33
KT190C96B	2, 33
KT190C96BL	2, 33
KT190C96W	2, 33
KT190C108B	2, 33
KT190C108BL	2, 33
KT190C108W	2, 33
KT190C120B	2, 33
KT190C120BL	2, 33
KT190C120W	2, 33
KT23BLVE	2, 32
KT23C	2, 32
KT23C-RADIUS	19, 32
KT23CE	2, 32
KT23D	2, 32
KT23D-RADIUS	19, 32
KT23DE	2, 32
DS369A7145B	2, 8, 9, 10, 11
KT426B	2, 15, 16
KT426BL	2, 15, 16
KT426W	2, 15, 16
KT427B	2, 15, 16
KT427B81	2, 15, 16
KT427B96	2, 15, 16
KT427BL	2, 15, 16
KT427BL81	2, 15, 16
KT427BL96	2, 15, 16
KT427W	2, 15, 16
KT427W81	2, 15, 16
KT427W96	2, 15, 16
KT428B96	2
KT428B144	2
KT428W96	2
KT428W144	2
KT428BL144	2
KT6562E3ISD	23
KT6916E3ISD	22
KT70C	2, 22, 23
KT70C-RADIUS	19
KT70D	2, 22, 23
KT70D-RADIUS	19
KT75C	2, 16, 17
KT75D	2, 16, 17
KT749BRONZE	2, 25
KT749DCH	2, 25
KT750SPC	8, 10
KT760SPC	10, 11, 12
KT770SPC	9, 11, 12, 13
KT780SPC	8, 9, 13
KT752E3FIRD	18
KT788E3C	18
KT788E3D	18
KT841REDUCER	9, 11, 13
KTDBSY	18
KTDBOC200NRG	24
KTDBOC200NRQ	24
KTDBOC200NRX	24
KTDBOC400NRG	24
KTDBOC400NRQ	24

KTDBOC400NRX	24
KTDBOE200NRG	24
KTDBOE200NRQ	24
KTDBOE200NRX	24
KTDBOE400NRG	24
KTDBOE400NRQ	24
KTDBOE400NRX	24
KTDBOE600NRG	24
KTDBOE600NRQ	24
KTDBOE600NRX	24
KTDBOE1000NRG	24
KTDBOE1000NRQ	24
KTDBOE1000NRX	24
KTDBOT200NRG	25
KTDBOT200NRQ	25
KTDBOT200NRX	25
KTDBOT400NRG	25
KTDBOT400NRQ	25
KTDBOT400NRX	25
KTDBOT600NRG	25
KTDBOT600NRQ	25
KTDBOT600NRX	25
KTDBOT1000NRG	25
KTDBOT1000NRQ	25
KTDBOT1000NRX	25
KTE3CICSTG	36, 37
KTE3CICSOL	36, 37
KTE3CICSS	36, 37
KTE3CLCSTG	36, 37
KTE3CLCSOL	36, 37
KTE3CLCSS	36, 37
KTE3CPSTG	36, 37
KTE3CPSOL	36, 37
KTE3CPSS	36, 37
KTE3CRCSTG	36, 37
KTE3CRC SOL	36, 37
KTE3CRCSS	36, 37
KTE3EHTG	36, 37
KTE3EHOL	36, 37
KTE3EHS	36, 37
KTE3HTG	36, 37
KTE3HOL	36, 37
KTE3HS	36, 37
KTE3HHTG	36, 37
KTE3HHOL	36, 37
KTE3HHS	36, 37
KTE3HHNHTG	36, 37
KTE3HHNHOL	36, 37
KTE3HHNHSS	36, 37
KTE3HNHTG	36, 37
KTE3HNNHOL	36, 37
KTE3HNNHSS	36, 37
KTE3HHNHSTG	36, 37
KTE3HHNHSSOL	36, 37
KTE3HHNHSS	36, 37
KTE3HHTG	36, 37
KTE3HHSOL	36, 37
KTE3HHSS	36, 37
KTE3HNNHSTG	36, 37
KTE3HNNHSSOL	36, 37
KTE3HNNHSS	36, 37

KTE3HSTG	36, 37
KTE3HSOL	36, 37
KTE3HSS	36, 37
KTE3WPSTG	36, 37
KTE3WPSOL	36, 37
KTE3WPSS	36, 37
DSP108-35BL	2, 5, 33
DS7145-270B	2, 16, 17, 22, 23
LEVER LOCK SETS	39
MULTIPOINT MK2	38

Misc / Spare & Replacement Parts

KT750GASKET	2
KT768GASKET	2, 32
KTDBPCS	24
KTDBSPQ	24, 25
KTDBSPS	24, 25
KTE2DBFORB	25
KTE3CBPIVOTH	36
KTE3DJ	2
KTE3HGASKET	4
KTE3SCREW TG	37
KTE3SCREWOL	37
KTE3SCREWSS	37
KTE3WPCUPQ	36
KTE3WPCUPS	36
KTEMAG	35
KTDBSPOCX or Q	24
KT740DHC	33
KT740DHD	33
KT740DHBL	33
KT740DHW	33
KT745ESPX	5, 7
KT745ESPQ	5, 7
KTDCAS	34
KTDCAOL	34

Twinpoint

ECLT2TRSN0924	27, 28, 29, 30
ECLT2TRSN0930	27, 28, 29, 30
ECLT2NS	27
ECDF3SHN	31
ECDF4SHNS	31
ECLTBC8S	30
ECLT2RB	29
ECLTSP8SS	30
ECLTSP8OL	30

E-CLAD

ECE3JCC	20, 21
ECE3WDM	20, 21
ECE3NBM	20, 21
ECE3HCC	20, 21
ECBRC	20, 21
ECSTRL	20, 21
ECGS	20, 21

Legend

X	Satin aluminum
G	Bright gold anodized
TG	PVD brass *
OL	PVD bronze
Q	Powder coat bronze
S	Stainless steel
C	Clear anodized
D	Bronze anodized
B	Brown
BVE	Black vinyl extrusion
BL	Black
DHC	Satin / clear
DHD	Bronze anodized
DHBL	Black powder coat
DHW	White powder coat
NK	Black pile
NG	Grey pile

* PVD brass (TG) finish is custom order, call for manufacturing time.

Swing

IS	Inswing
OS	Outswing

Misc

SPC	Sill protective cover
GASKET	A/B gasket
FORB	Router bit
FIR	Fir top mould
DJ	Drill jig for hinges

Lengths For Flushbolts

7-7/8"	(200mm)
15-3/4"	(400mm)
23-5/8"	(600mm)
39-3/8"	(1000mm)

Hardware

ICS	Intermediate carrier 3 piece set
LCS	Left carrier 2 piece set
RCS	Right corner 2 piece set
PS	Pivot top & bottom 2 piece set
EH	"D" pull handle 1 piece
H	Hinge flat with handle 1 piece
HH	Hinge offset with handle 1 piece
HHH	Hinge flat no handle 1 piece
HHNH	Hinge offset no handle 1 piece
HS	Hinge flat with handle 3 piece set
HHS	Hinge offset with handle 3 piece set
HHHS	Hinge flat no handle 3 piece set
HHNHSS	Hinge offset no handle 3 piece set
WP	Wall pivot

Misc / Spare Hardware Components

PCS	End cap for OC flushbolts pin
SP	Striker plate
CBP	Bottom pivot housing
PCP	Pivot cap
SCREW	Screws for hinge flaps
WPCUP	Wall pivot jamb cup only
SPOC	Striker plate OC flushbolt
TPPLATE	Top pivot mounting plate
DH	Door hold

Flushbolts

KTDBOT	For outswing application
KTDBOC	For inswing application installed at bottom of panels
KTDBOE	For inswing application installed at top of panels

E3™ Architectural Detail

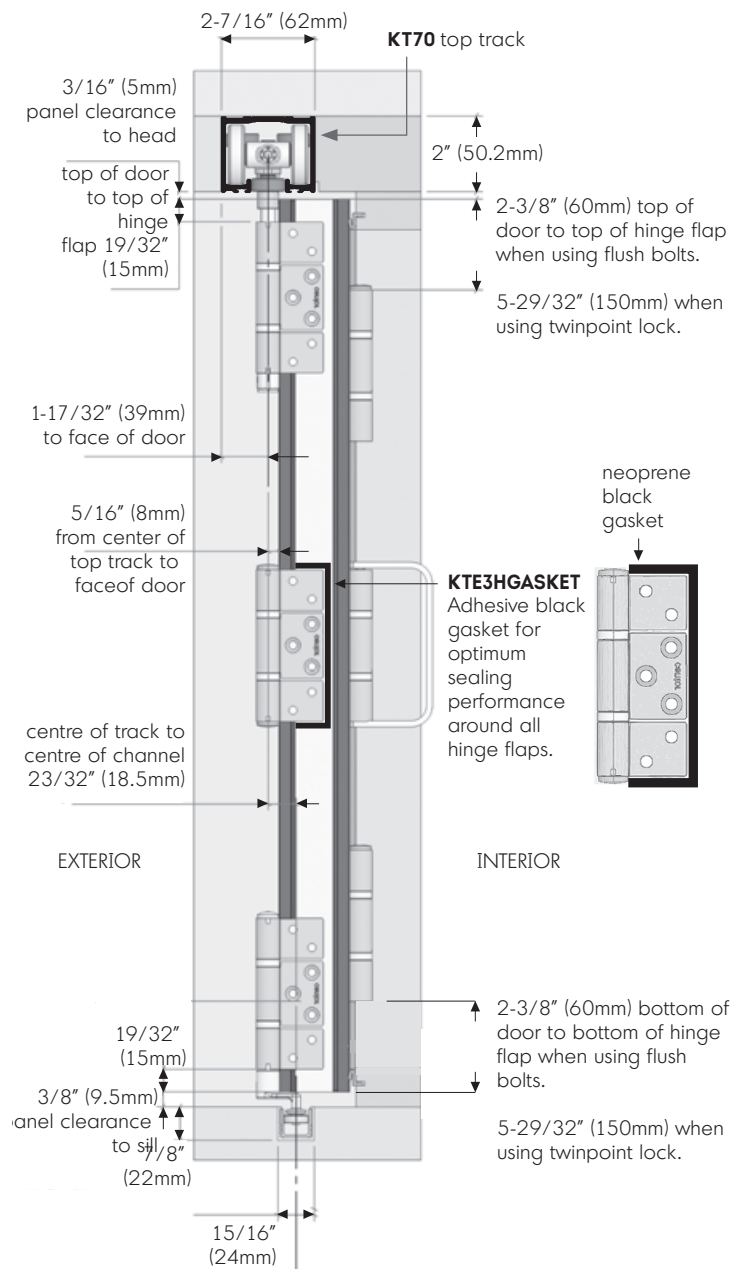
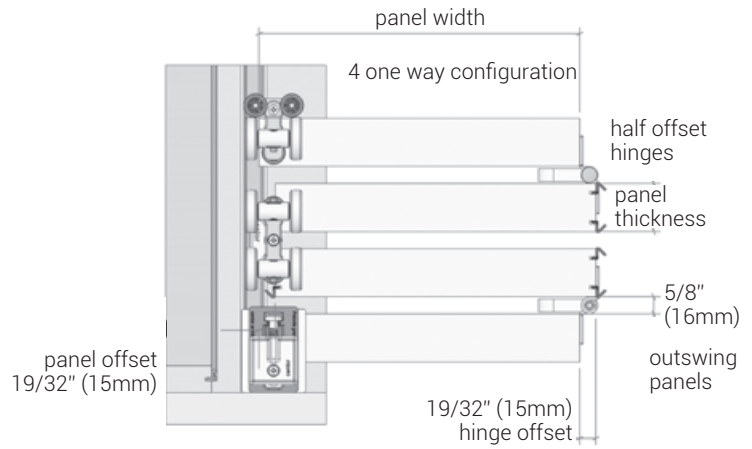
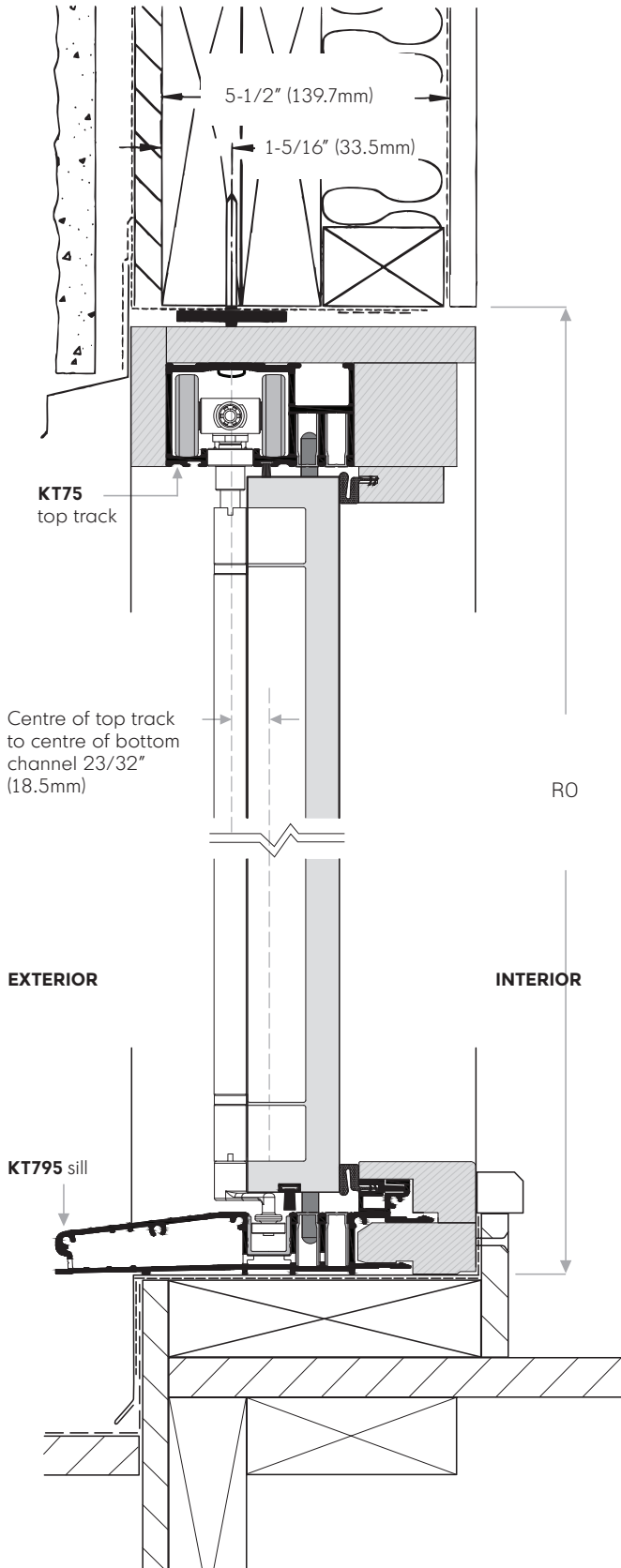

NO SCALE

E3™ Architectural Detail

NOTE: When using 2-1/4" (57mm) panel thickness panel to jamb should be 1/2" (12.7mm) clearance. Hinge flap should be machined into edge of door.

Outswing Application

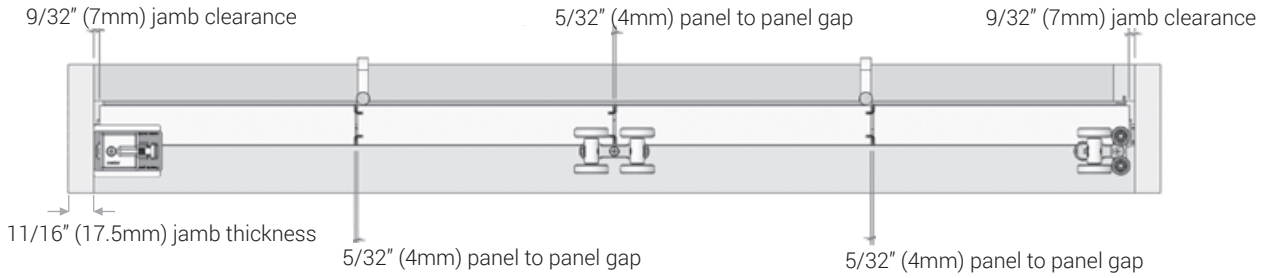

4L (4 doors folding left) Exterior View (all doors are same width)

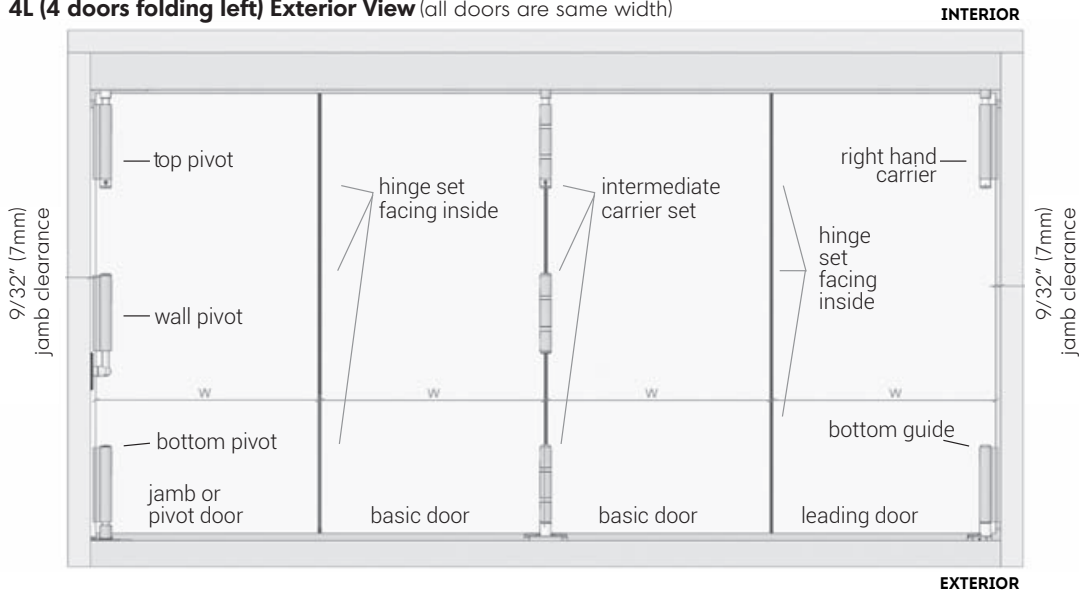

KT426 & KTP108-35 Weatherseal Detail for 1-3/4" (44.5mm) Door

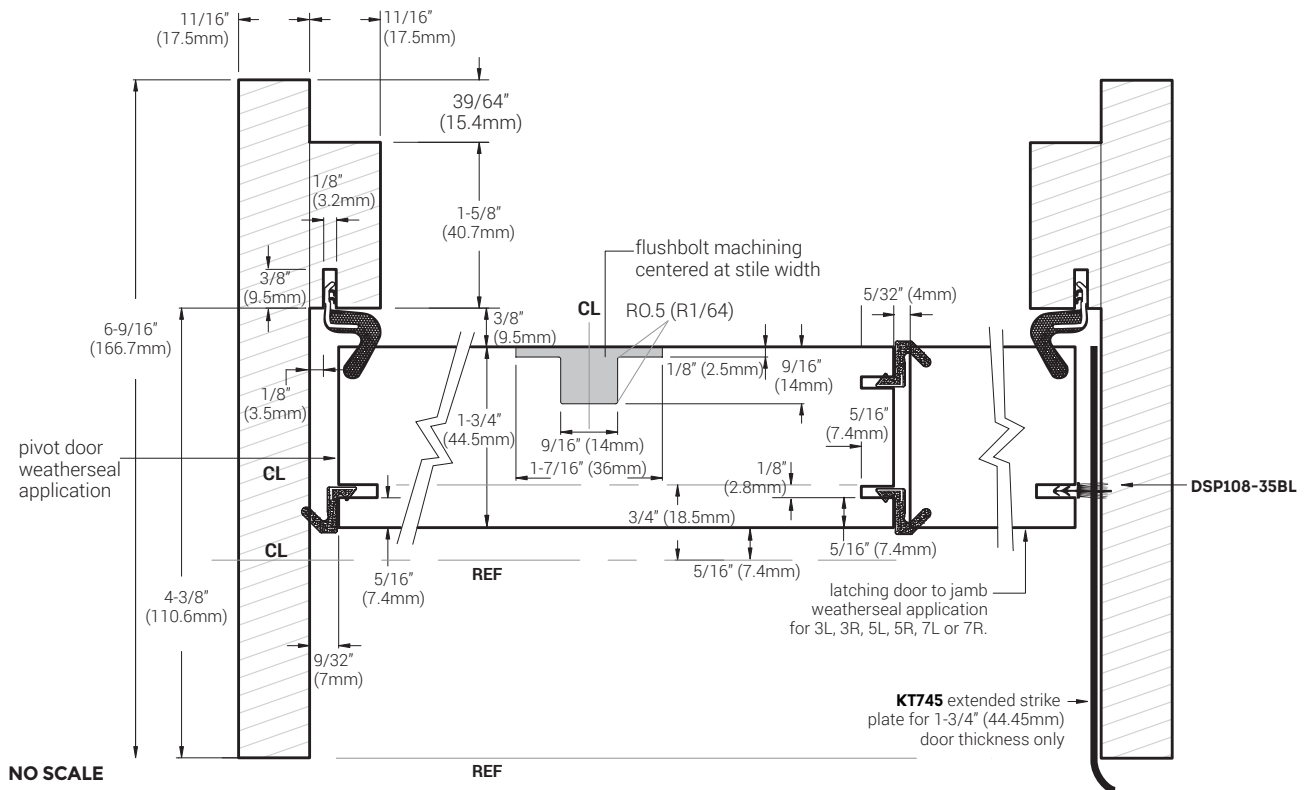

Hardware List For Door Configurations

Passage Set/Lock, Flushbolt, Astragal & Hardware Placement For Outswing Applications

FROM LEFT TO RIGHT

2L		1x KTE3WPS Middle Wall Pivot 1x KTE3CPS Pivot Set 1x KTE3CRCS Right Carrier Set 1x KTE3HS Hinge Set 2x KTDB Non-Keyed Flushbolt
2L1R		2x KTE3WPS Middle Wall Pivot 2x KTE3CPS Pivot Set 1x KTE3CRCS Right Carrier Set 1x KTE3HS Hinge Set 2x KTDB Non-Keyed Flushbolt
3L		1x KTE3WPS Middle Wall Pivot 1x KTE3CPS Pivot Set 1x KTE3CICS Intermediate Carrier Set 1x KTE3HHS Half Offset Hinge Set 2x KTDB Non-Keyed Flushbolt
3L1R		2x KTE3WPS Middle Wall Pivot 2x KTE3CPS Pivot Set 1x KTE3CICS Intermediate Carrier Set 1x KTE3HHS Half Offset Hinge Set 4x KTDB Non-Keyed Flushbolt
4L		1x KTE3WPS Middle Wall Pivot 1x KTE3CPS Pivot Set 1x KTE3CICS Intermediate Carrier Set 1x KTE3CRCS Right Carrier Set 2x KTE3HHS Half Offset Hinge Set 4x KTDB Non-Keyed Flushbolt
4L1R		2x KTE3WPS Middle Wall Pivot 2x KTE3CPS Pivot Set 1x KTE3CICS Intermediate Carrier Set 1x KTE3CRCS Right Carrier Set 2x KTE3HHS Half Offset Hinge Set 4x KTDB Non-Keyed Flushbolt
3L2R		2x KTE3WPS Middle Wall Pivot 2x KTE3CPS Pivot Set 1x KTE3CICS Intermediate Carrier Set 1x KTE3CLCS Left Carrier Set 1x KTE3HS Hinge Set 1x KTE3HHS Half Offset Hinge Set 4x KTDB Non-Keyed Flushbolt
5L		1x KTE3WPS Middle Wall Pivot 1x KTE3CPS Pivot Set 2x KTE3CICS Intermediate Carrier Set 1x KTE3HS Hinge Set 1x KTE3HHS Half Offset Hinge Set 4x KTDB Non-Keyed Flushbolt
3L3R		2x KTE3WPS Middle Wall Pivot 2x KTE3CPS Pivot Set 2x KTE3CICS Intermediate Carrier Set 2x KTE3HHS Half Offset Hinge Set 6x KTDB Non-Keyed Flushbolt
7L		1x KTE3WPS Middle Wall Pivot 1x KTE3CPS Pivot Set 3x KTE3CICS Intermediate Carrier Set 2x KTE3HS Hinge Set 1x KTE3HHS Half Offset Hinge Set 6x KTDB Non-Keyed Flushbolt
4L3R		2x KTE3WPS Middle Wall Pivot 2x KTE3CPS Pivot Set 2x KTE3CICS Intermediate Carrier Set 1x KTE3CRCS Right Carrier Set 3x KTE3HHS Half Offset Hinge Set 6x KTDB Non-Keyed Flushbolt
5L2R		2x KTE3WPS Middle Wall Pivot 2x KTE3CPS Pivot Set 2x KTE3CICS Intermediate Carrier Set 1x KTE3CLCS Left Carrier Set 2x KTE3HS Hinge Set 1x KTE3HHS Half Offset Hinge Set 6x KTDB Non-Keyed Flushbolt
5L3R		2x KTE3WPS Middle Wall Pivot 2x KTE3CPS Pivot Set 3x KTE3CICS Intermediate Carrier Set 1x KTE3HS Hinge Set 2x KTE3HHS Half Offset Hinge Set 8x KTDB Non-Keyed Flushbolt
6L		1x KTE3WPS Middle Wall Pivot 1x KTE3CPS Pivot Set 2x KTE3CICS Intermediate Carrier Set 1x KTE3CRCS Right Carrier Set 1x KTE3HS Hinge Set 2x KTE3HHS Half Offset Hinge Set 6x KTDB Non-Keyed Flushbolt

Hardware Legend

- PS** Pivot Set
- WPS** Wall Pivot Set
- ICS** Intermediate Carrier Set
- LCS** Left Carrier Set
- RCS** Right Carrier Set
- HHS** Half Offset Hinge Set
- HS** Hinge Set (Flat)
- FB** Flushbolt
- ESP** Extended Strike Plate
- DH** Door Hold
- MAG** Magnet
- TP** Twinpoint

Legend

- Passage Set Lock by Other**
- Flushbolts Top & Bottom**
- Twinpoint Option to FB**
- Astragal**
- Door Hold**
- Extended Strike Plate for 1-3/4" Door Only**

KT745ESPX
Satin finish

KT745ESPO
Bronze powder coat

Floating Door Pairs

INTERIOR

EXTERIOR

Per pair of doors:

- 1x KTE3CLCS Left Carrier Set
- 1x KTE3CRCS Right Carrier Set
- 1x KTE3HS Hinge Set
- 2x KTDB Non-Keyed Flushbolt

How To Determine Swing Of Systems

Configuration is always determined when viewing system from exterior side, going from left to right.

3L

OUTSWING

3LI

INSWING

outswing application "D" pull handle option

3L

Use one "D" pull handle on each pair of inswing doors to pull open and close doors.

Inswing application "D" pull handle option

SRI

Use "D" pull handle on exit door (outswing system) where passage set / lock not required. Use flushbolts top and bottom to lock door from the inside only. Note : exit door not accessible from exterior.

NO SCALE

Hardware List For Door Configurations

Passage Set/Lock, Flushbolt, Astragal & Hardware Placement For Outswing Applications

FROM LEFT TO RIGHT

2R	<p>INTERIOR: Not accessible from exterior.</p> <p>EXTERIOR: LCS, FB, PS, WPS, HS</p>	<p>1x KTE3WPS Middle Wall Pivot 1x KTE3CPS Pivot Set 1x KTE3CLCS Left Carrier Set 1x KTE3HS Hinge Set 2x KTDB Non-Keyed Flushbolt</p>
1L2R	<p>INTERIOR: WPS, PS</p> <p>EXTERIOR: LCS, FB, HS, WPS, PS</p>	<p>2x KTE3WPS Middle Wall Pivot 2x KTE3CPS Pivot Set 1x KTE3CLCS Left Carrier Set 1x KTE3HS Hinge Set 2x KTDB Non-Keyed Flushbolt</p>
3R	<p>INTERIOR: ICS, WPS, PS</p> <p>EXTERIOR: ESP, DH, FB, HHS, WPS, PS</p>	<p>1x KTE3WPS Middle Wall Pivot 1x KTE3CPS Pivot Set 1x KTE3CICS Intermediate Carrier Set 1x KTE3HHS Half Offset Hinge Set 2x KTDB Non-Keyed Flushbolt</p>
1L3R	<p>INTERIOR: WPS, PS</p> <p>EXTERIOR: ICS, FB, DH, HHS, WPS, PS</p> <p>may be reversed</p>	<p>2x KTE3WPS Middle Wall Pivot 2x KTE3CPS Pivot Set 1x KTE3CICS Intermediate Carrier Set 1x KTE3HHS Half Offset Hinge Set 4x KTDB Non-Keyed Flushbolt</p>
2L2R	<p>INTERIOR: WPS, PS, RCS, LCS, WPS, PS</p> <p>EXTERIOR: FB, HS, Not accessible from exterior, FB, HS</p>	<p>2x KTE3WPS Middle Wall Pivot 2x KTE3CPS Pivot Set 1x KTE3CLCS Left Carrier Set 1x KTE3RCS Right Carrier Set 2x KTE3HS Hinge Set 4x KTDB Non-Keyed Flushbolt</p>
1L4R	<p>INTERIOR: WPS, PS, LCS, ICS, WPS, PS</p> <p>EXTERIOR: FB, HS, FB, HS, HHS, HHS</p>	<p>2x KTE3WPS Middle Wall Pivot 2x KTE3CPS Pivot Set 1x KTE3CICS Intermediate Carrier Set 1x KTE3CLCS Left Carrier Set 2x KTE3HHS Half Offset Hinge Set 4x KTDB Non-Keyed Flushbolt</p>
4R	<p>INTERIOR: LCS, ICS, WPS, PS</p> <p>EXTERIOR: Not accessible from exterior, FB, HS, FB, HS, HHS, HHS</p>	<p>1x KTE3WPS Middle Wall Pivot 1x KTE3CPS Pivot Set 1x KTE3CICS Intermediate Carrier Set 1x KTE3CLCS Left Carrier Set 2x KTE3HHS Half Offset Hinge Set 4x KTDB Non-Keyed Flushbolt</p>
2L3R	<p>INTERIOR: WPS, PS, RCS, ICS, WPS, PS</p> <p>EXTERIOR: FB, HS, RCS, FB, HS, DH, HHS</p>	<p>2x KTE3WPS Middle Wall Pivot 2x KTE3CPS Pivot Set 1x KTE3CICS Intermediate Carrier Set 1x KTE3RCS Right Carrier Set 1x KTE3HS Hinge Set 1x KTE3HHS Half Offset Hinge Set 4x KTDB Non-Keyed Flushbolt</p>
5R	<p>INTERIOR: ICS, ICS, WPS, PS</p> <p>EXTERIOR: ESP, DH, FB, HS, FB, HS, HHS</p>	<p>1x KTE3WPS Middle Wall Pivot 1x KTE3CPS Pivot Set 2x KTE3CICS Intermediate Carrier Set 1x KTE3HS Hinge Set 1x KTE3HHS Half Offset Hinge Set 4x KTDB Non-Keyed Flushbolt</p>
3L4R	<p>INTERIOR: WPS, PS, ICS, LCS, ICS, WPS, PS</p> <p>EXTERIOR: FB, HS, DH, FB, HS, FB, HS, HHS, HHS</p>	<p>2x KTE3WPS Middle Wall Pivot 2x KTE3CPS Pivot Set 2x KTE3CICS Intermediate Carrier Set 1x KTE3CLCS Left Carrier Set 3x KTE3HHS Half Offset Hinge Set 6x KTDB Non-Keyed Flushbolt</p>
7R	<p>INTERIOR: ICS, ICS, ICS, WPS, PS</p> <p>EXTERIOR: DH, HS, FB, HS, FB, HS, HHS</p>	<p>1x KTE3WPS Middle Wall Pivot 1x KTE3CPS Pivot Set 3x KTE3CICS Intermediate Carrier Set 2x KTE3HS Hinge Set 1x KTE3HHS Half Offset Hinge Set 6x KTDB Non-Keyed Flushbolt</p>
2L5R	<p>INTERIOR: WPS, PS, RCS, ICS, ICS, WPS, PS</p> <p>EXTERIOR: FB, HS, RCS, FB, HS, FB, HS, HHS</p>	<p>2x KTE3WPS Middle Wall Pivot 2x KTE3CPS Pivot Set 2x KTE3CICS Intermediate Carrier Set 2x KTE3RCS Right Carrier Set 2x KTE3HS Hinge Set 1x KTE3HHS Half Offset Hinge Set 6x KTDB Non-Keyed Flushbolt</p>
8R	<p>INTERIOR: ICS, ICS, ICS, WPS, PS</p> <p>EXTERIOR: Not accessible from exterior, LCS, FB, HS, FB, HS, FB, HS, HHS, HHS</p>	<p>1x KTE3WPS Middle Wall Pivot 1x KTE3CPS Pivot Set 3x KTE3CICS Intermediate Carrier Set 1x KTE3CLCS Left Carrier Set 2x KTE3HS Hinge Set 2x KTE3HHS Half Offset Hinge Set 8x KTDB Non-Keyed Flushbolt</p>

Hardware Legend	
PS	Pivot Set
WPS	Wall Pivot Set
ICS	Intermediate Carrier Set
LCS	Left Carrier Set
RCS	Right Carrier Set
HHS	Half Offset Hinge Set
HS	Hinge Set (Flat)
FB	Flushbolt
ESP	Extended Strike Plate
DH	Door Hold
MAG	Magnet
TP	Twinpoint

Legend	
	Passage Set Lock by Other
	Flushbolts Top & Bottom
	Twinpoint Option to FB
	Astragal
	Door Hold
	Extended Strike Plate for 1-3/4" Door Only
	4"
	4-5/16"
	KT745ESPX Satin finish
	KT745ESPO Bronze powder coat

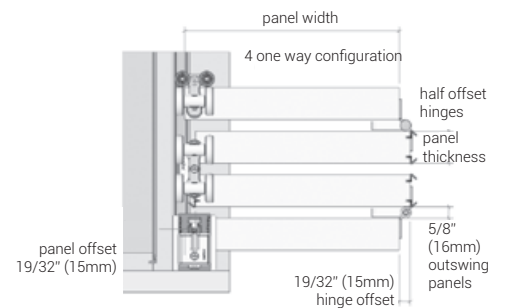

Hardware Application 3L2R

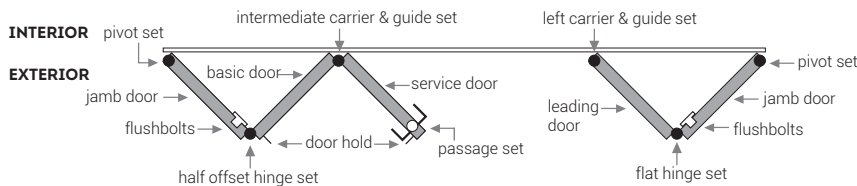

NO SCALE

Eclipse, KT797 (8") Outswing Sill System For 2-1/4" (57mm) Door Thickness

Extrusion Alloy 6063 T5. Actual Full Sill Width: 8" (203mm) Channel Sill for Flushbolt or Twinpoint.

New Generation Sill with Flushbolt Pin Channel. Sill is fabricated as shown by Eclipse Architectural.



- KT797E3FIRC** Clear anodized
- KT797E3FIRD** Bronze anodized

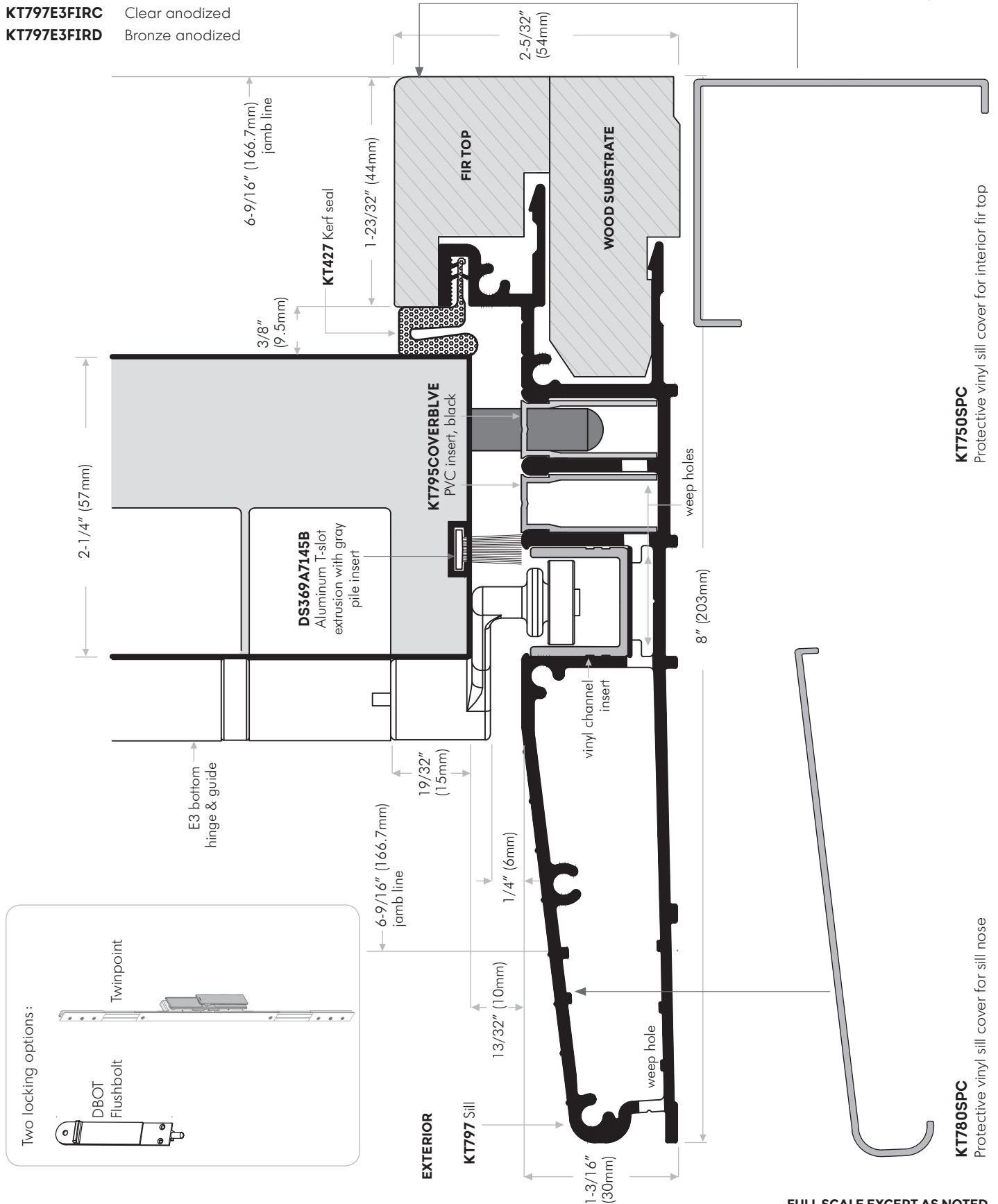

FULL SCALE EXCEPT AS NOTED

Eclipse KT777 (6-9/16") Outswing Sill System For 2-1/4" (57mm) Door Thickness

Extrusion Alloy 6063 T5. Actual Full Sill Width: 6-9/16" (166.7mm) Channel Sill for Flushbolt or Twinpoint.

New Generation Sill with Flushbolt Pin Channel. Sill is fabricated as shown by Eclipse Architectural.



- KT777E3FIRC** Clear anodized
- KT777E3FIRD** Bronze anodized

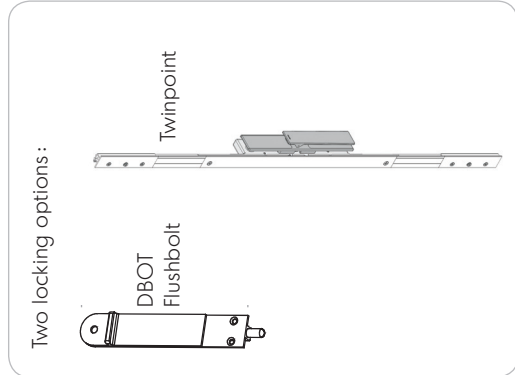
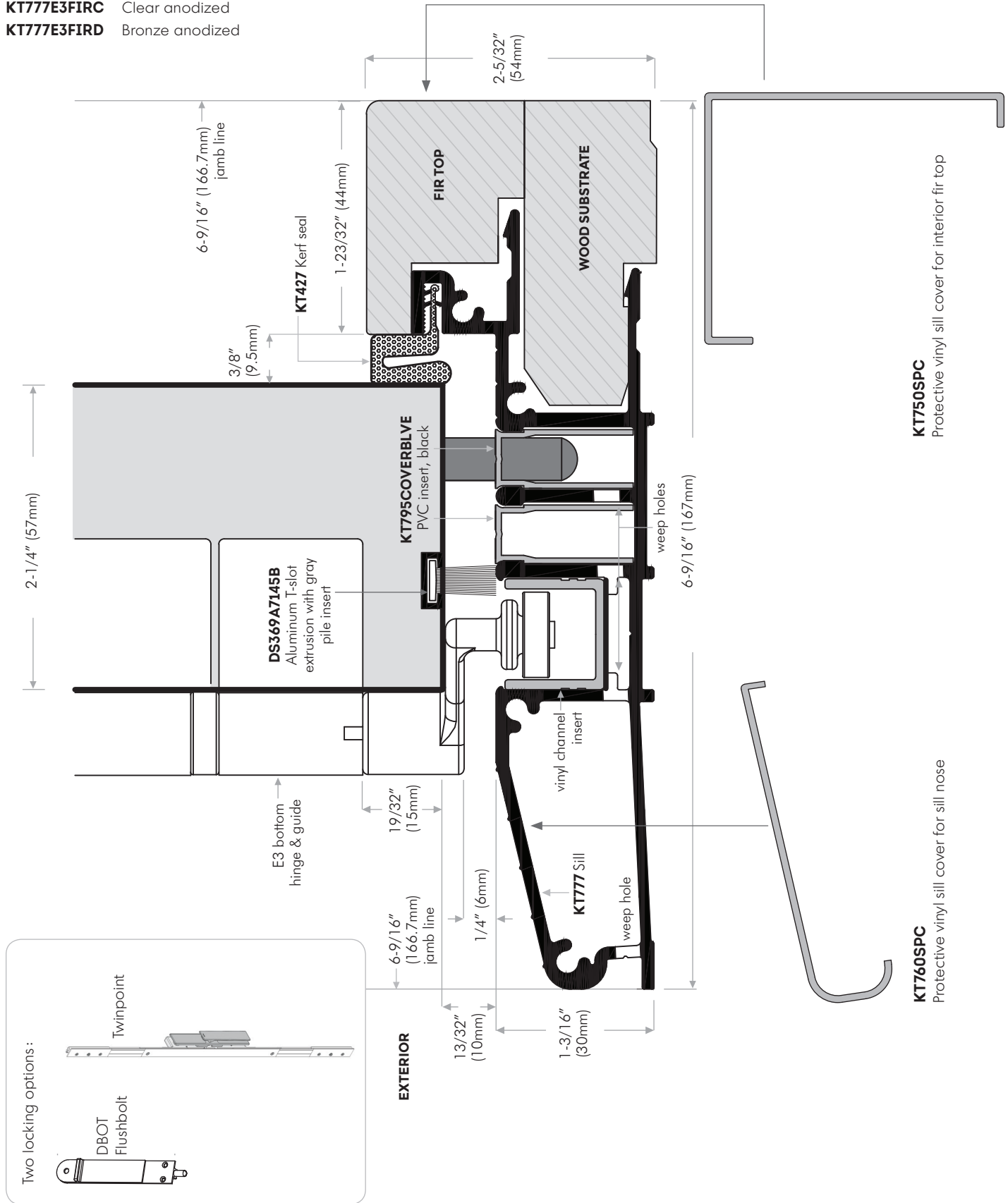

FULL SCALE EXCEPT AS NOTED

Eclipse KT775 (6-9/16") Outswing Sill System For 1-3/4" (44.5mm) Door Thickness

Extrusion Alloy 6063 T5. Actual Full Sill Width: 6-9/16" (166.7mm) Channel Sill for Flushbolt or Twinpoint.

New Generation Sill with Flushbolt Pin Channel. Sill is fabricated as shown by Eclipse Architectural.



- KT775E3FIRC** Clear anodized
- KT775E3FIRD** Bronze anodized

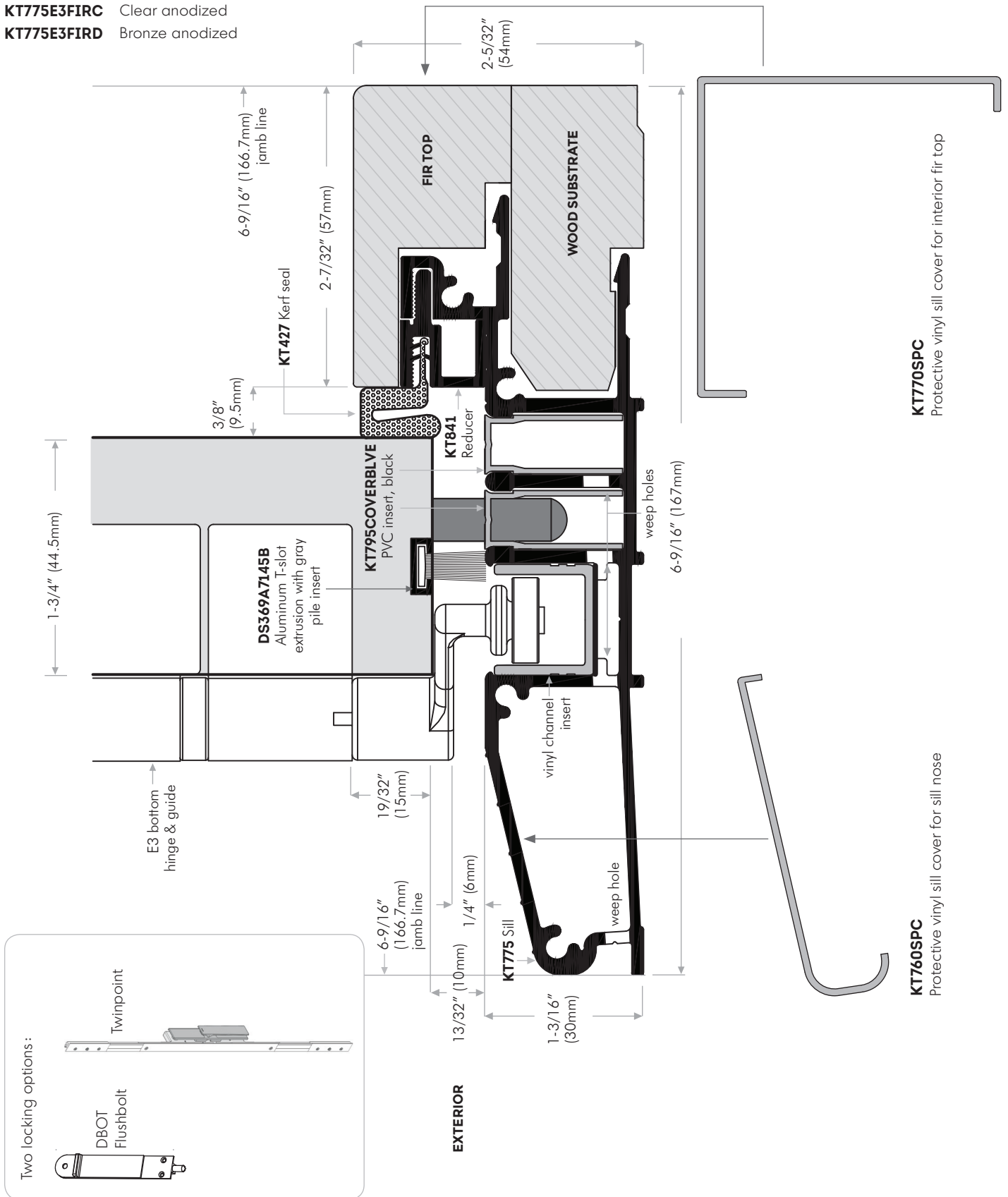

FULL SCALE EXCEPT AS NOTED

Eclipse KT776 (6-9/16") Outswing Sill System For 1-3/4" (44.5mm) Door Thickness

Extrusion Alloy 6063 T5. Actual Full Sill Width: 6-9/16" (166.7mm) Channel Sill for Flushbolt or Twinpoint.

New Generation Sill with Flushbolt Pin Channel. Sill is fabricated as shown by Eclipse Architectural.



- KT776E3TVC** Clear anodized with PVC top, tan
- KT776E3TVD** Bronze anodized with PVC top, tan

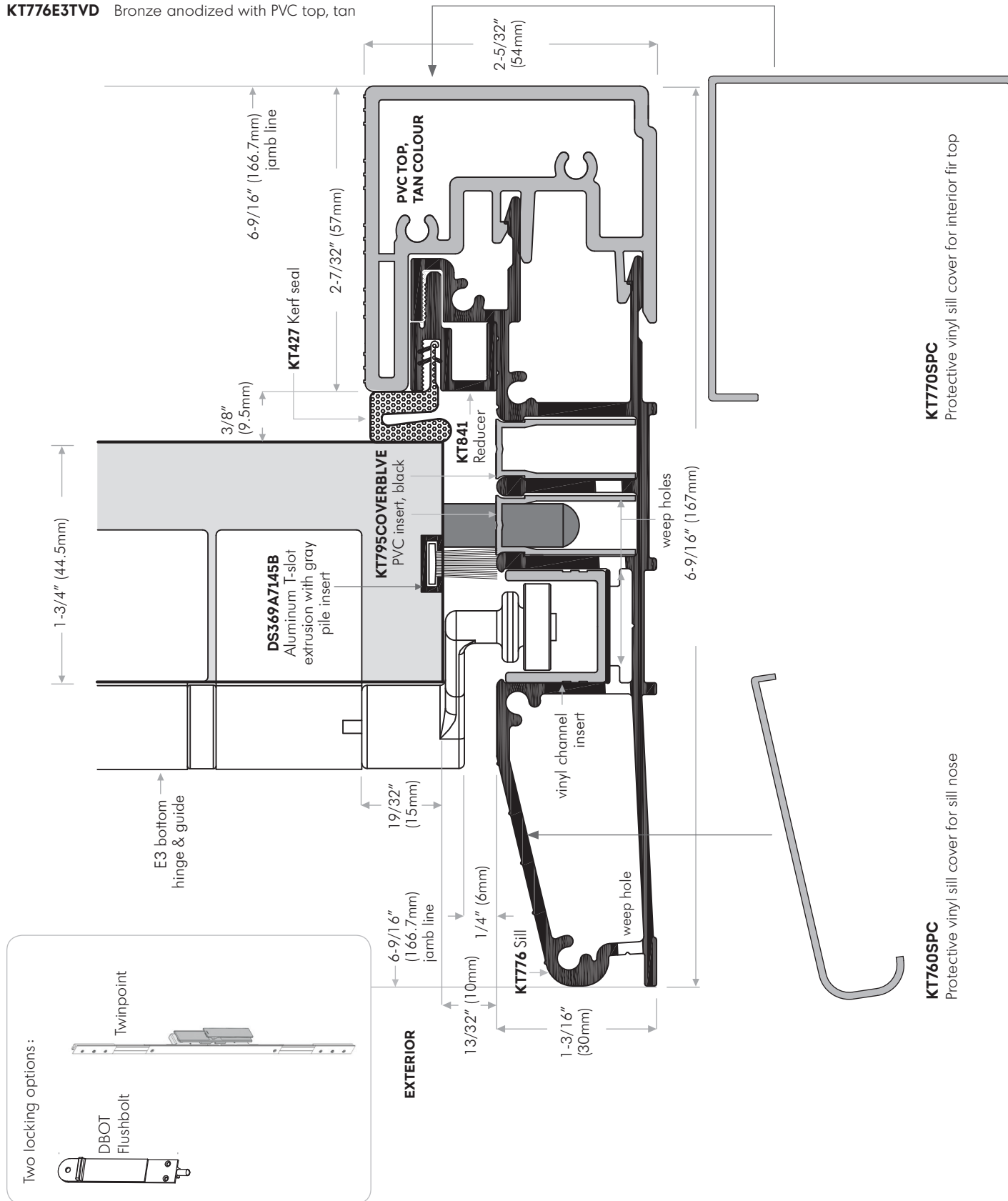

FULL SCALE EXCEPT AS NOTED



Eclipse KT796 (8") Outswing Sill System For 1-3/4" (44.5mm) Door Thickness

Extrusion Alloy 6063 T5. Actual Full Sill Width: 8" (203mm) Channel Sill for Flushbolt or Twinpoint.

New Generation Sill with Flushbolt Pin Channel. Sill is fabricated as shown by Eclipse Architectural.

- KT796E3TVC** Clear anodized with PVC top, tan
- KT796E3TVD** Bronze anodized with PVC top, tan

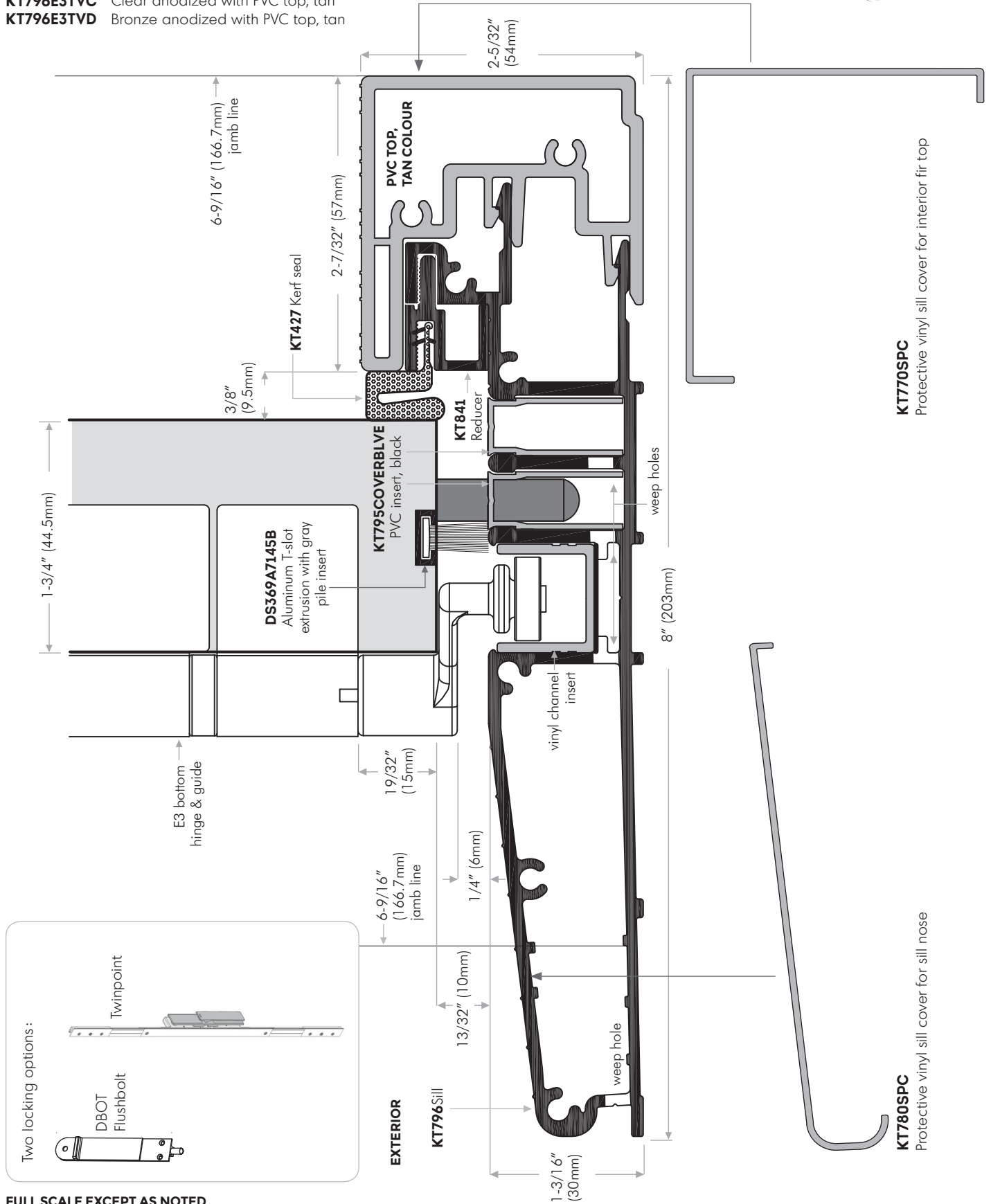

FULL SCALE EXCEPT AS NOTED

E3™ Jamb For 1-3/4" (44.5mm) Door Thickness

Exterior E3 Folding Door, Outswing Application.

Actual machining for flushbolts (face plate)

- 1-27/64" x 7-7/8" (36mm x 200mm)
- 1-27/64" x 15-3/4" (36mm x 400mm)
- 1-27/64" x 23-5/8" (36mm x 600mm)
- 1-27/64" x 39-3/8" (36mm x 1000mm)

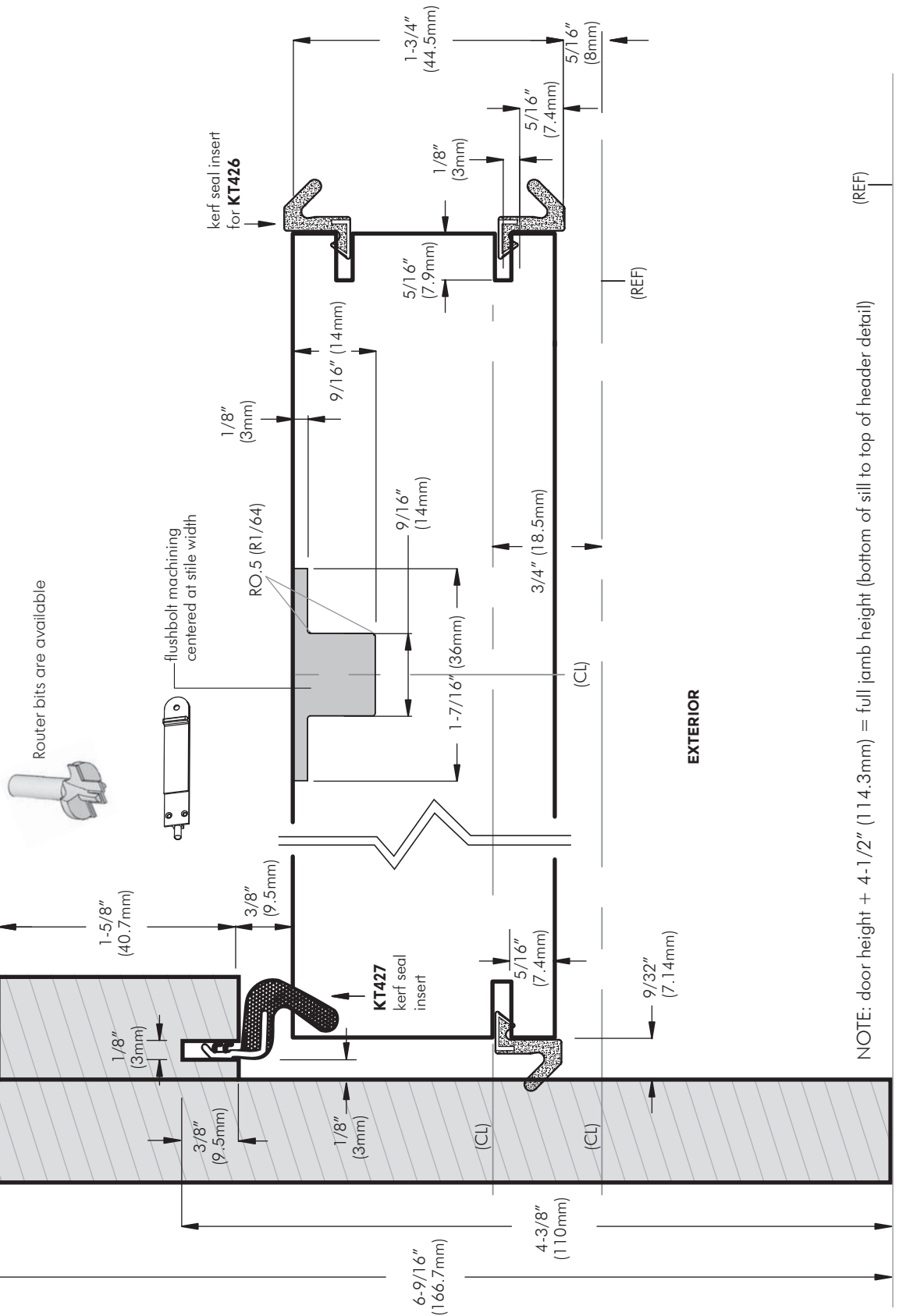

NOTE: door height + 4-1/2" (114.3mm) = full jamb height (bottom of sill to top of header detail) (REF)

FULL SCALE EXCEPT AS NOTED

KT75 Top Track E3™ Header For 2-1/4" (57mm) Door Thickness

Exterior E3 Folding Door, KT75 Outswing Application Only. Channel Top Track for Flushbolt or Twinpoint.

New Generation Top Track with Flushbolt Pin Channel.



KT75C Clear

KT75D Bronze anodized

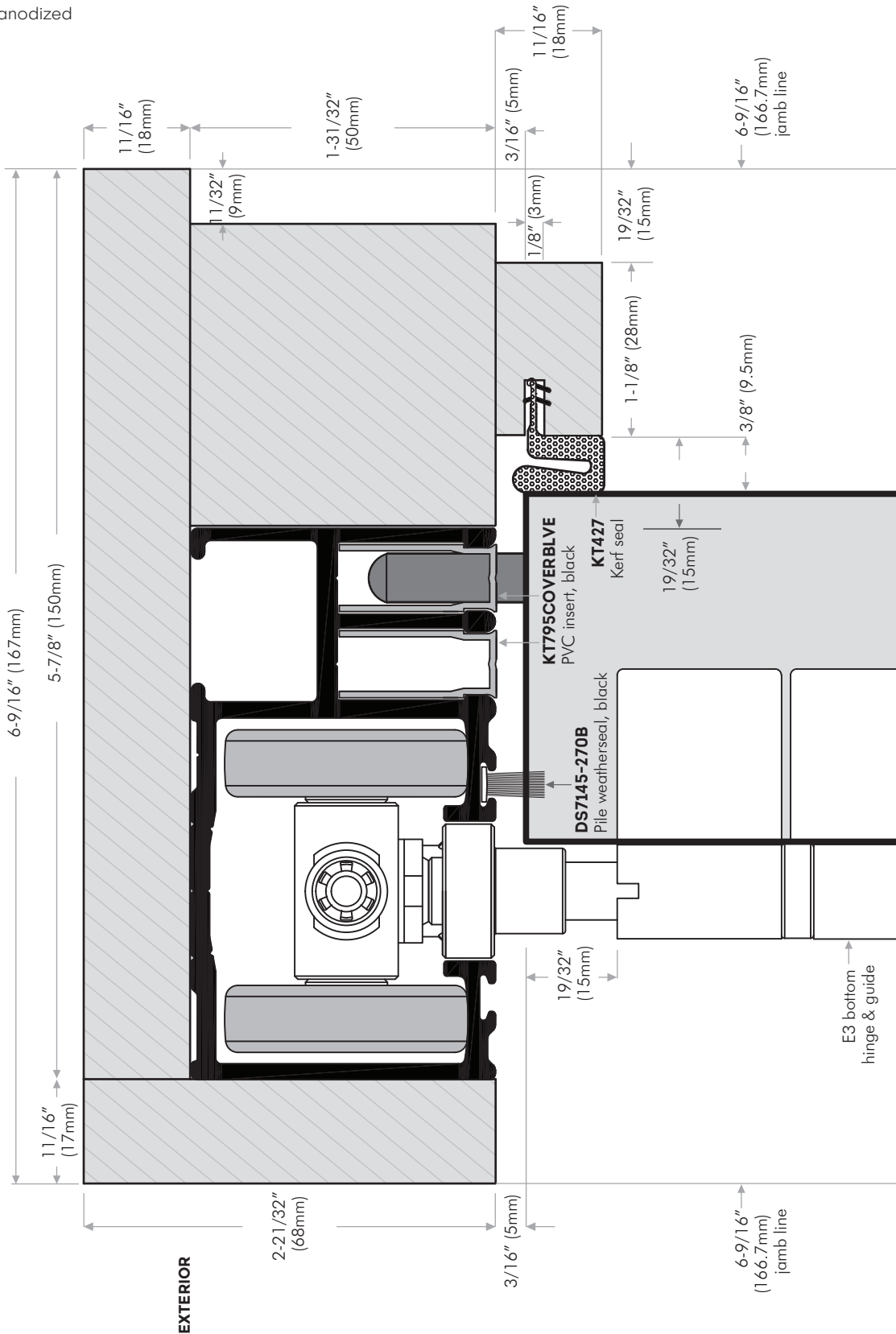

FULL SCALE EXCEPT AS NOTED

KT75 Top Track E3™ Header For 1-3/4" (44.5mm) Door Thickness

Exterior E3 Folding Door, KT75 Outswing Application Only. Channel Top Track for Flushbolt or Twinpoint.

New Generation Top Track with Flushbolt Pin Channel.



- KT75C** Clear anodized
- KT75D** Bronze anodized

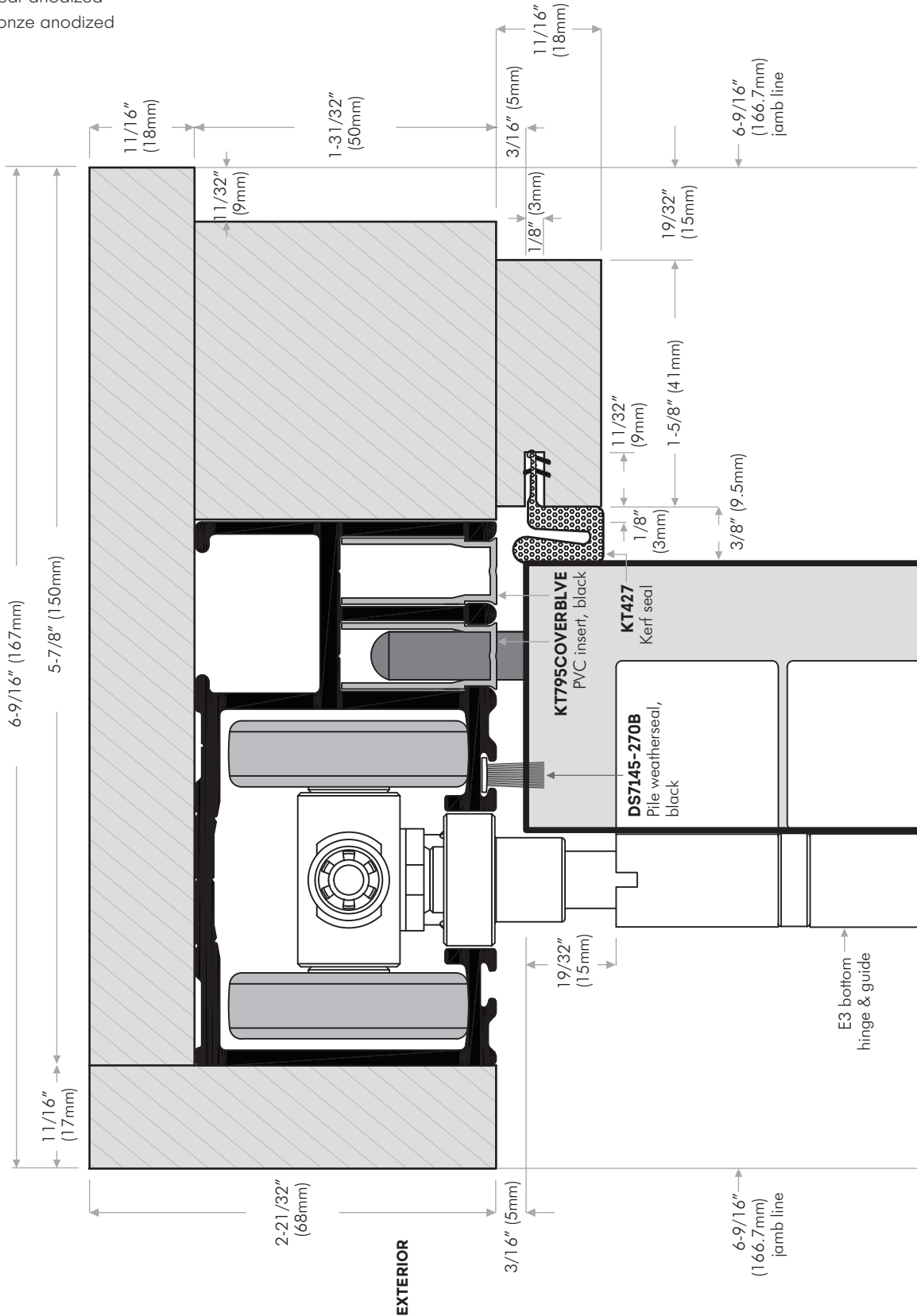

FULL SCALE EXCEPT AS NOTED

KT752 Series E3™ 5-1/2" (139.7mm) Outswing Sill System

ONLY FOR 1-3/4" (44.5mm) Door Thickness & 4-9/16" (115.8 mm) Wall Thickness

BRONZE ANODIZED ONLY

KT752E3FIRD Outswing sill with fir top, bronze anodized

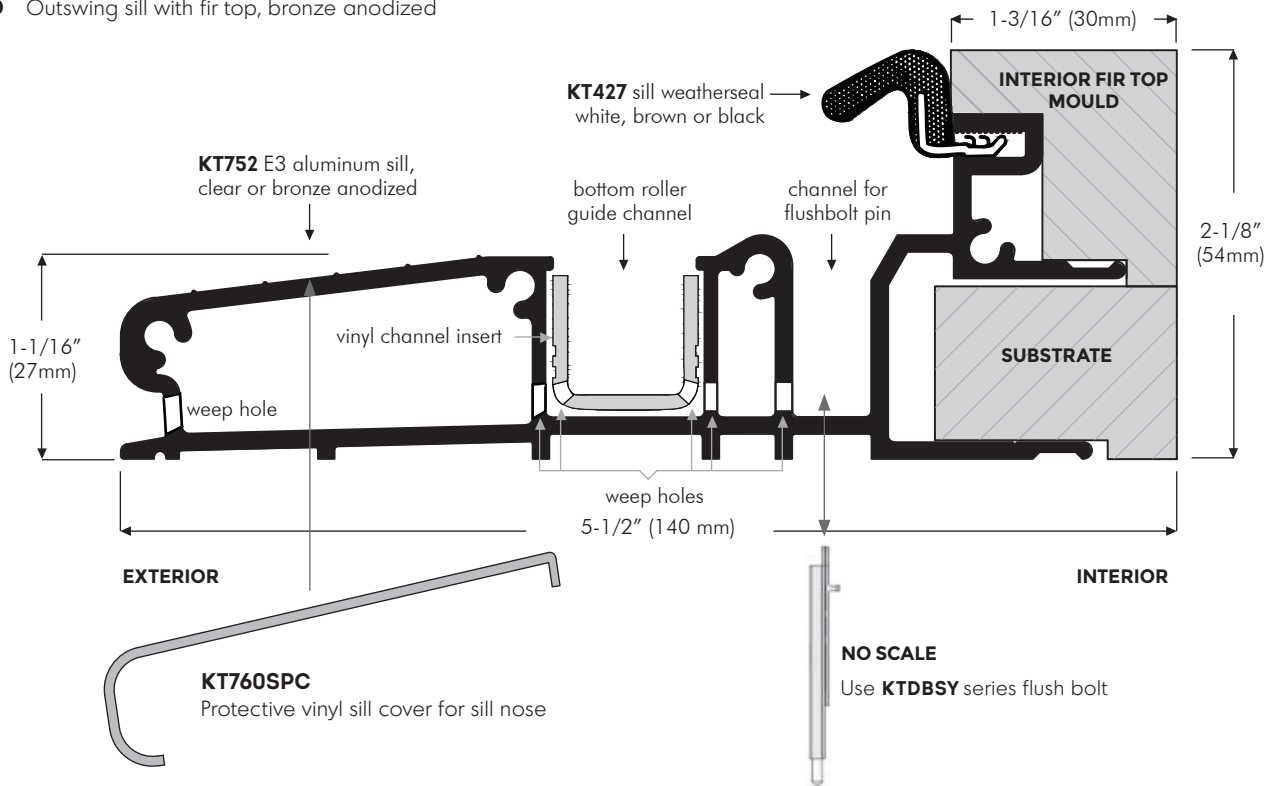

KT788 E3 ADA Lowrise Aluminum Sill for Inswing & Outswing Doors

NOTE: Door height plus 4-1/4" (107.9mm) = R.O. (from finished floor line to R.O. header) when using Eclipse frame specs.

KT788E3C Clear anodized
KT788E3D Bronze anodized

ADA Compliant

EXTERIOR

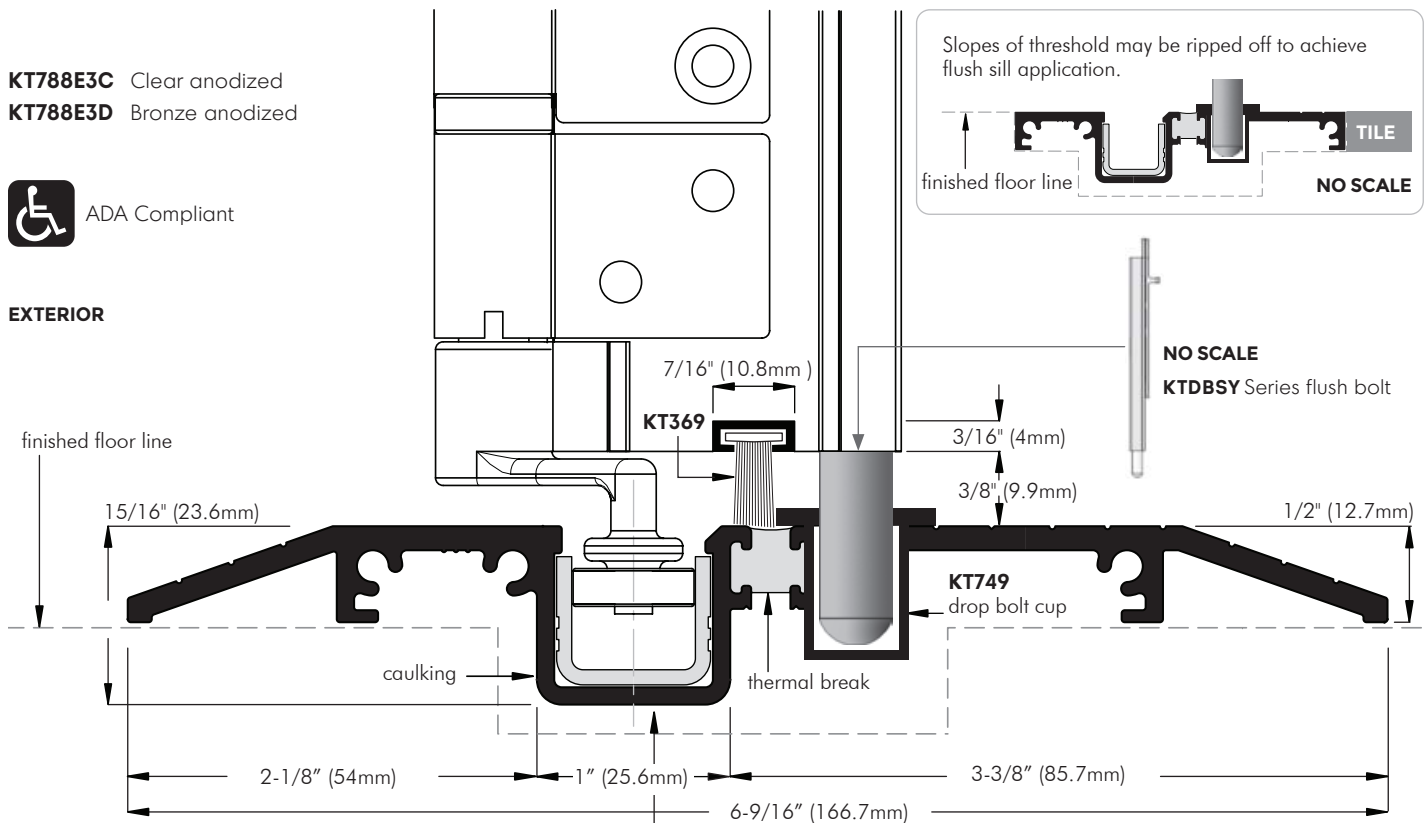

NOTE: Block concrete for recessed channel and flushbolt cup.

FULL SCALE EXCEPT AS NOTED

E3™ Corner Unit Application

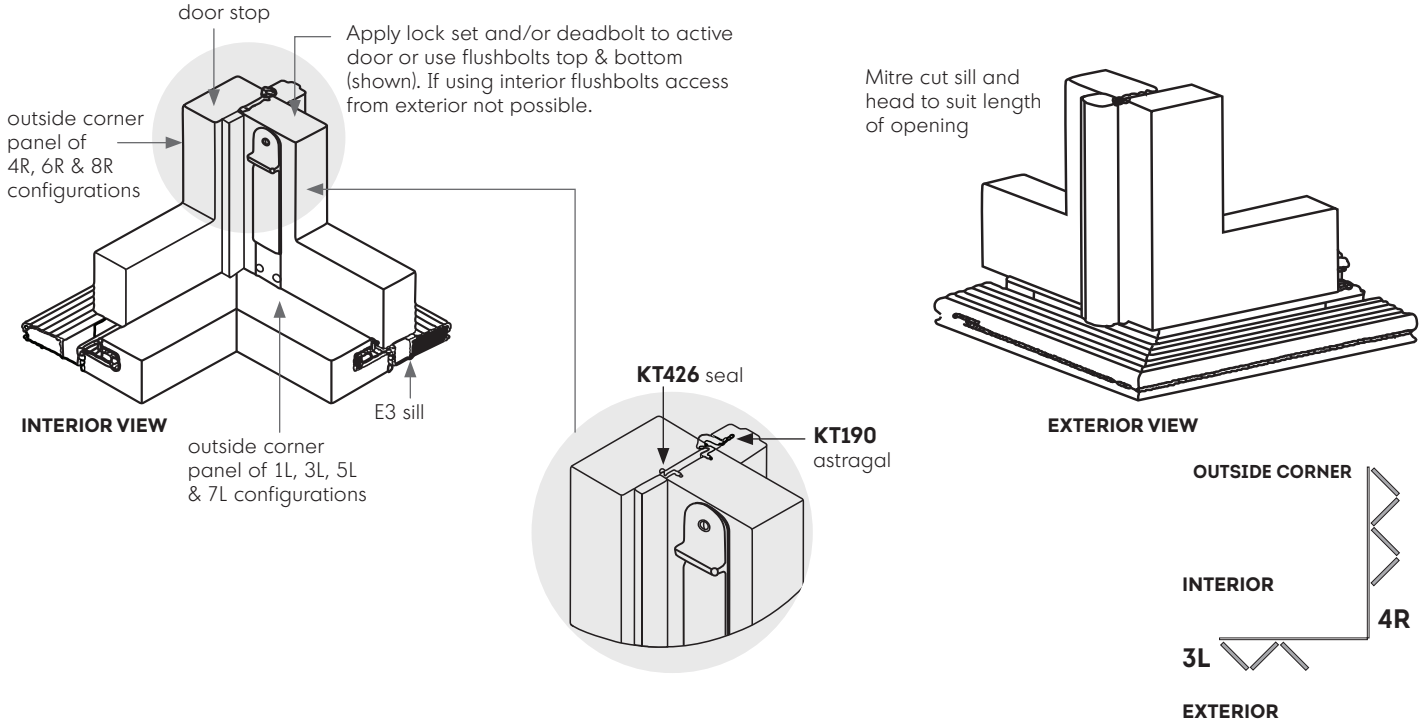

Radius Application

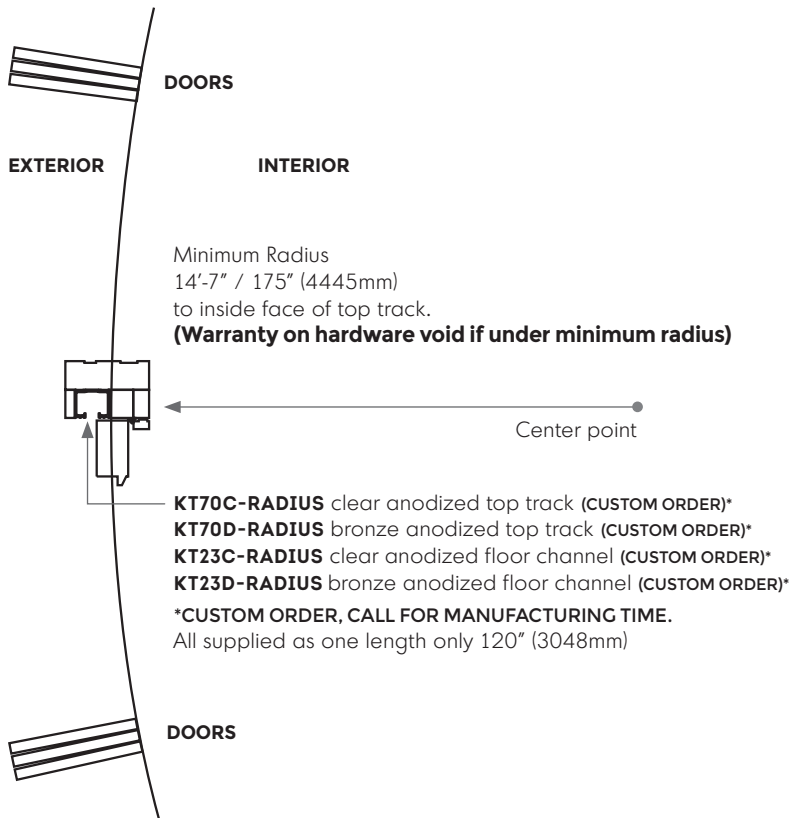

Arc Length (AL)

R = Radius (length from the C.P. to the edge of the circle)
C = chord length
X = height of crown
CP = center point
AL = arc length

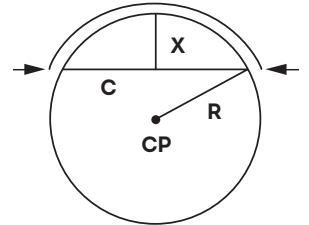

NO SCALE

E3 E-Clad Exterior Cladding (Aluminum Extrusion) For E3 Systems Only

For Head & Jambs With 2 Styles Aluminum Brick Moulds

Available in white, bronze or black powder coat.



ECE3JCC Jamb cover clad (aluminum)

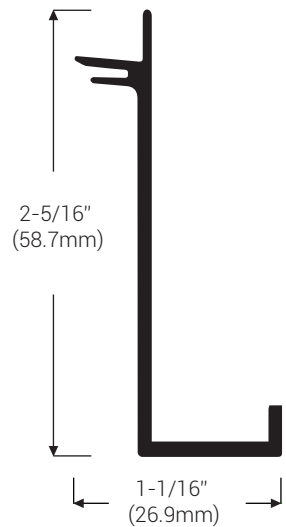

ECE3HCC
Head cover clad
(aluminum)

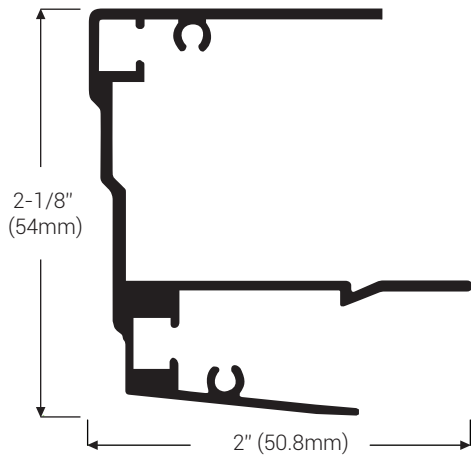

ECE3WBM Wide brick mould (aluminum)

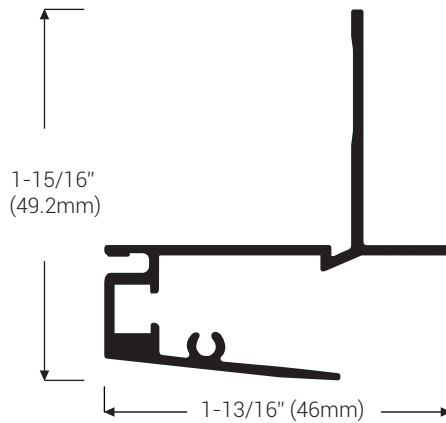

ECE3NBM Wide brick mould with flange (aluminum)

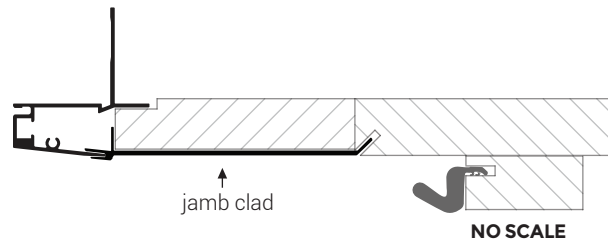
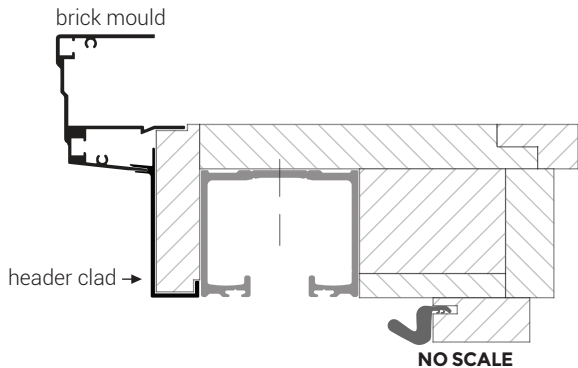
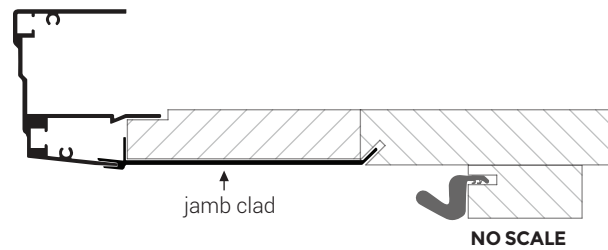
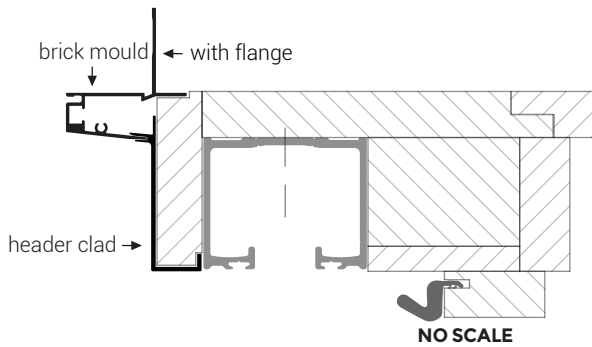

FULL SCALE EXCEPT AS NOTED

Door Clad Extruded Aluminum

Clad Extrusions only For Stile & Rail Wood Door

Available in white, bronze or black powder coat.

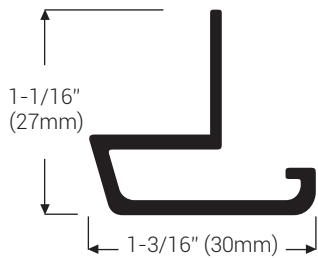
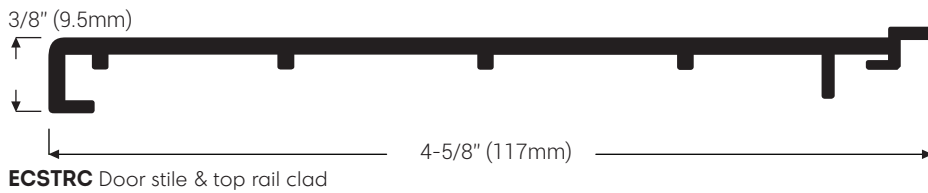
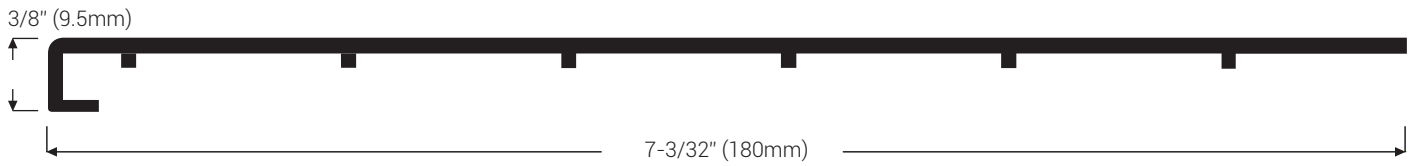

ECGS Glass stop

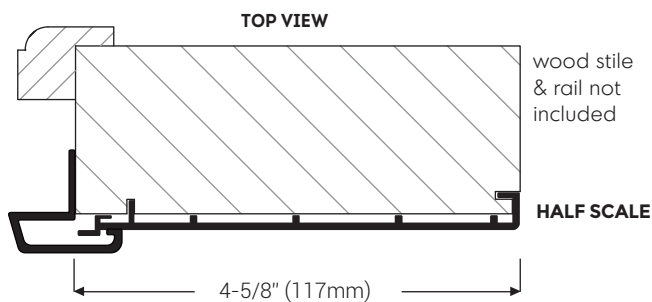

Door stile & top rail with exterior clad & glass stop

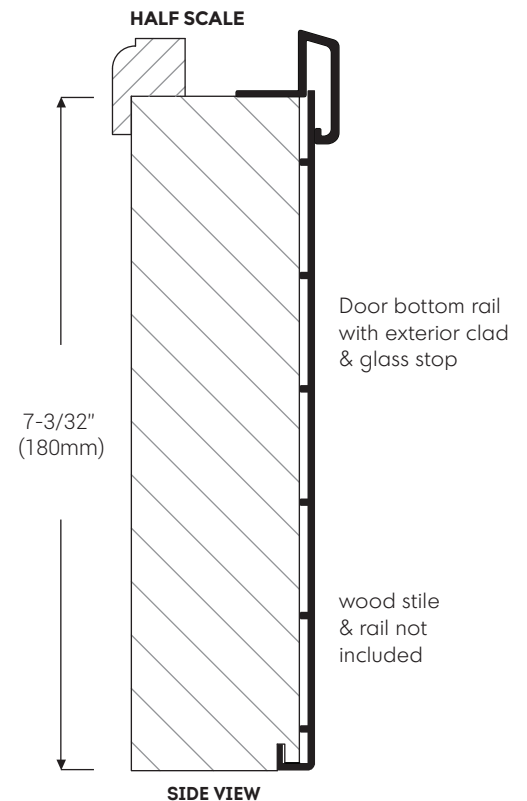

FULL SCALE EXCEPT AS NOTED

KT6916 E3™ Sill System For 2-1/4" (57mm) Door Thickness

BRONZE ANODIZED ONLY

Water Return All Aluminum Sill System, Thermally Broken For Inswing Folding Doors
 (Only KT70 Top Track can only be used on inswing application)

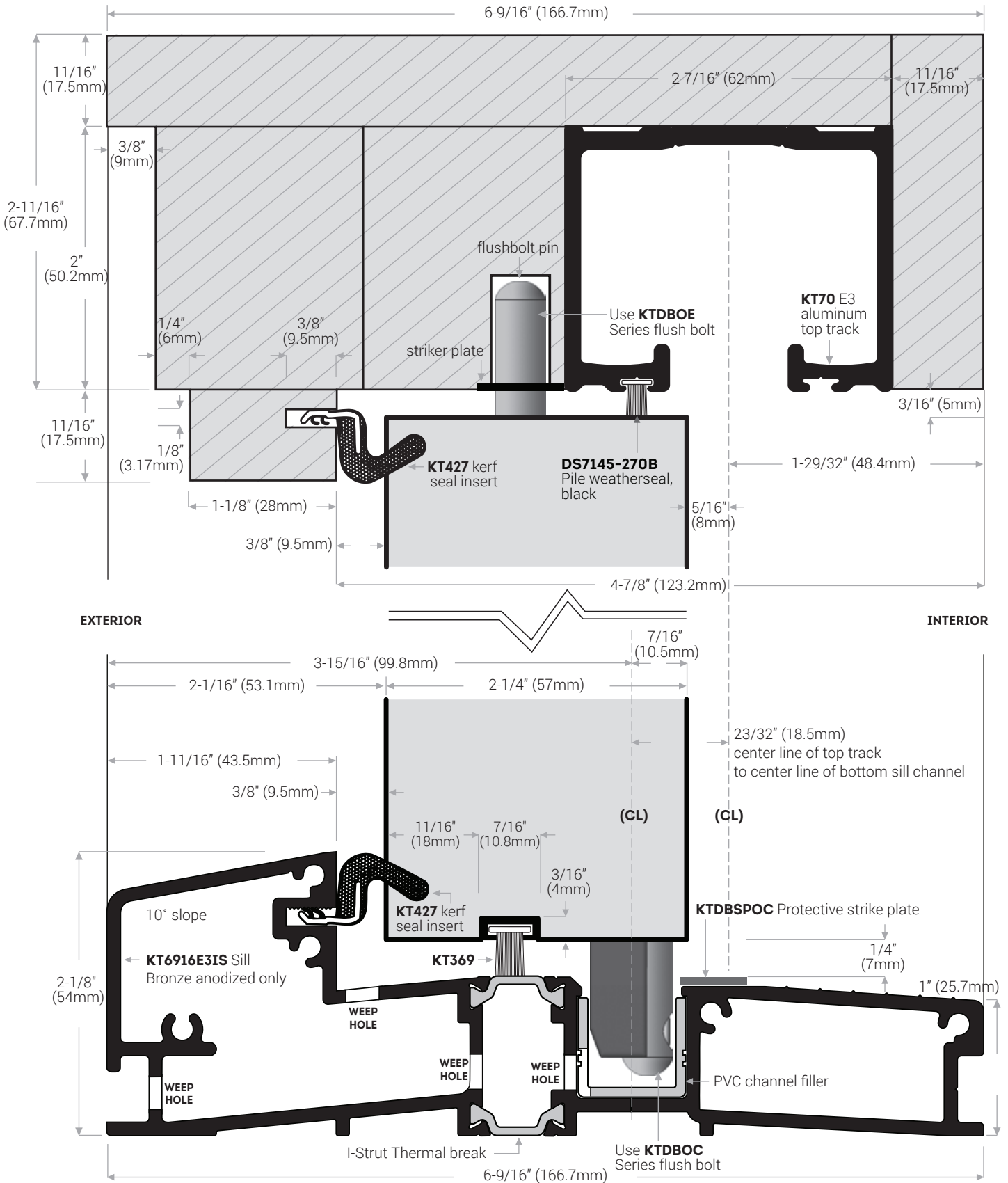

FULL SCALE EXCEPT AS NOTED

KT6562 E3™ Sill System For 1-3/4" (44.5mm) Door Thickness BRONZE ANODIZED ONLY

Water Return All Aluminum Sill System, Thermally Broken For Inswing Folding Doors
 (Only KT70 Top Track can only be used on inswing application)

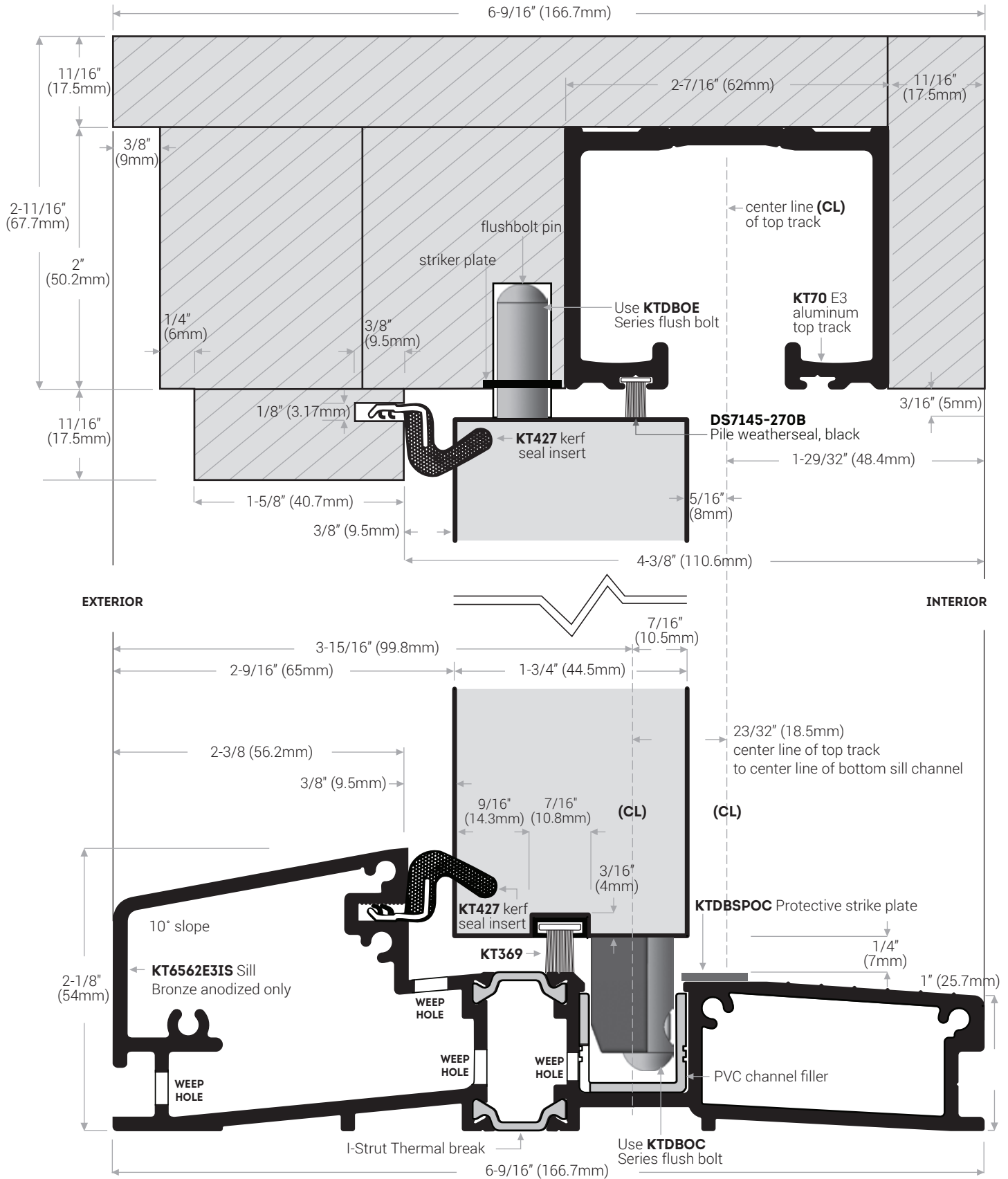

FULL SCALE EXCEPT AS NOTED

Flushbolts For E3 Eclipse Inswing Folding Doors: DBOE & DBOC Series

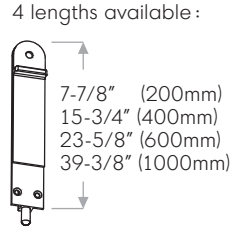
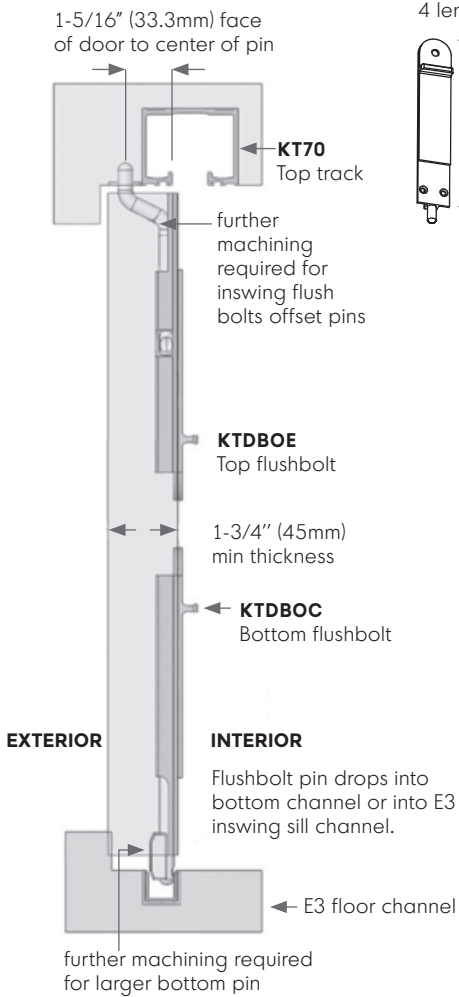

SPECIFICATIONS

Minimum door thickness: 1-3/4" (44.5mm)

Throw length: 3/4" (20mm)

Finishes:

Bronze powder coat on aluminum to match the pvd bronze hardware.
Brushed metallic to match stainless steel hardware.

* PVD brass (TG) to match pvd brass hardware.

* **PVD brass (TG) finish is custom order, call for manufacturing time.**

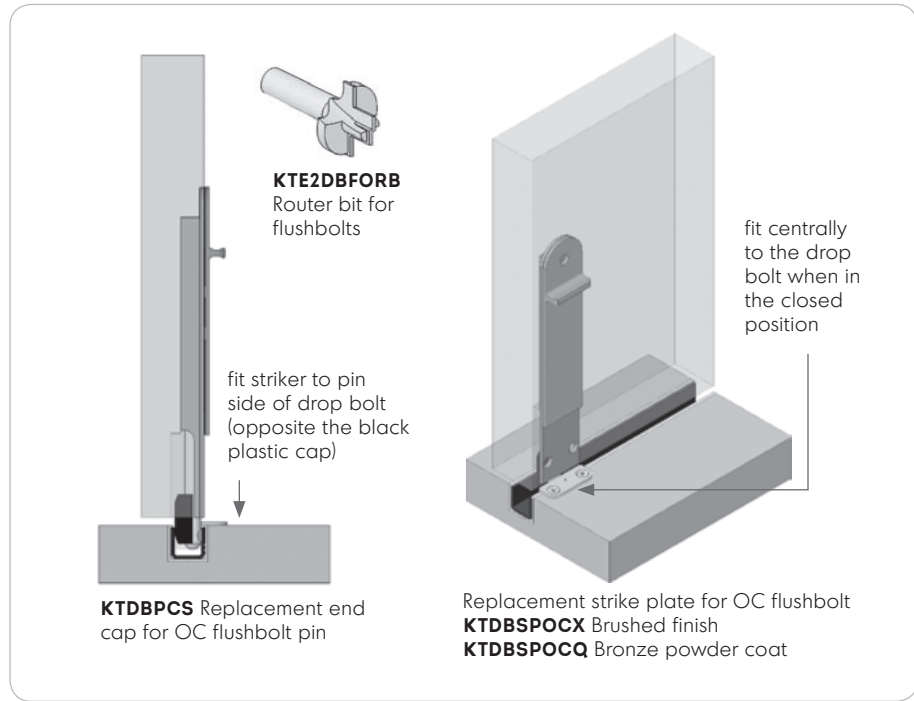

OC flushbolt for bottom of doors



OE flushbolt for top of doors

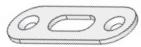

Strike plate for header
KTDBSPQ bronze powder coat
KTDBSPS Satin chrome

Actual machining for flushbolts (face plate)

1-27/64" x 7-7/8" (36mm x 200mm)
1-27/64" x 15-3/4" (36mm x 400mm)
1-27/64" x 23-5/8" (36mm x 600mm)
1-27/64" x 39-3/8" (36mm x 1000mm)



KTE2DBFORB Router bit for flushbolts

PRODUCT CODE

DESCRIPTION

KTDBOC200NRQ	200mm concealed flushbolt, bronze powder coat
KTDBOE200NRQ	200mm flushbolt, bronze powder coat
KTDBOE400NRQ	400mm flushbolt, bronze powder coat
KTDBOE600NRQ	600mm flushbolt, bronze powder coat
KTDBOE1000NRQ	1000mm flushbolt, bronze powder coat
KTDBOC200NRX	200mm concealed flushbolt, brushed metallic
KTDBOE200NRX	200mm flushbolt, brushed metallic
KTDBOE400NRX	400mm flushbolt, brushed metallic
KTDBOE600NRX	600mm flushbolt, brushed metallic
KTDBOE1000NRX	1000mm flushbolt, brushed metallic
* KTDBOC200NRG	200mm concealed flushbolt, PVD brass
* KTDBOE200NRG	200mm flushbolt, PVD brass
* KTDBOE400NRG	400mm flushbolt, PVD brass
* KTDBOE600NRG	600mm flushbolt, PVD brass
* KTDBOE1000NRG	1000mm flushbolt, PVD brass

* **PVD brass finish is custom order, call for manufacturing time.**

PLEASE NOTE: Flushbolt housing & slide bar are manufactured from aluminum components

NO SCALE

Flushbolts For E3 Eclipse Outswing Folding Doors: DBOT Series

SPECIFICATIONS

Max wind load: 450kg (990lb) force
Min door thickness: 1-3/4" (44.5mm)
Throw length: 1" (25mm)

Finishes:

Bronze powder coat on aluminum to match the pvd bronze hardware.
 Brushed metallic to match stainless steel hardware.
 *PVD brass (TG) to match pvd brass hardware.

***PVD brass (TG) finish is custom order, call for manufacturing time.**

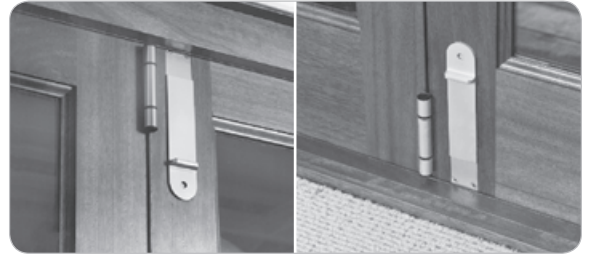

The flush-mounted flushbolts, rounded style and 1" (25mm) throw are designed for use with sliding and folding doors. This flushbolt will resist high winds and is rated to resist a 250kg load in Western Red Cedar and 450kg in Amoorra. The bolts are easily installed with a dedicated router bit and are available in three finishes.

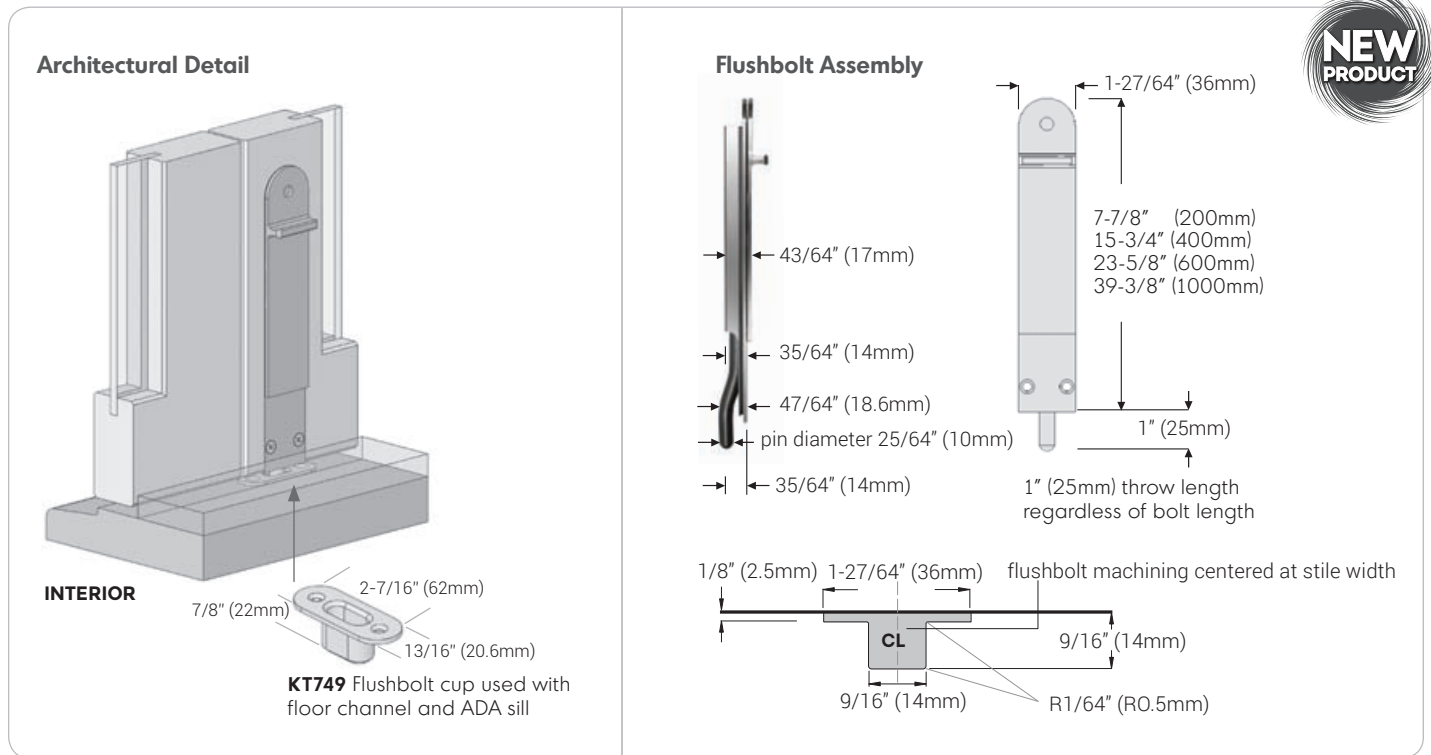

Actual machining for flushbolts (face plate)

1-27/64" x 7-7/8" (36mm x 200mm) 1-27/64" x 23-5/8" (36mm x 600mm)
 1-27/64" x 15-3/4" (36mm x 400mm) 1-27/64" x 39-3/8" (36mm x 1000mm)

SELECT FINISH	PRODUCT NUMBER	DESCRIPTION
bronze powder coat finish on aluminum	KTDBOT200NRQ	200mm, 1" throw, round end
	KTDBOT400NRQ	400mm, 1" throw, round end
	KTDBOT600NRQ	600mm, 1" throw, round end
	KTDBOT1000NRQ	1000mm, 1" throw, round end
brushed metallic finish on aluminum to match stainless steel	KTDBOT200NRX	200mm, 1" throw, round end
	KTDBOT400NRX	400mm, 1" throw, round end
	KTDBOT600NRX	600mm, 1" throw, round end
	KTDBOT1000NRX	1000mm, 1" throw, round end
pvd brass finish on aluminum	* KTDBOT200NRG	200mm, 1" throw, round end
	* KTDBOT400NRG	400mm, 1" throw, round end
	* KTDBOT600NRG	600mm, 1" throw, round end



Flushbolt cup used with floor channel and ADA sill
KT749BRONZE bronze powder coat
KT749DCH Satin chrome

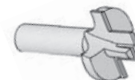

KTE2DBFORB Router bit for flushbolts (dedicated router bits are available)



Strike plate for header
KTDBSPQ bronze powder coat
KTDBSPS Satin chrome

PLEASE NOTE: Flushbolt housing & slide bar are manufactured from aluminum components

NO SCALE

New E3 Sills with Two Locking Options

For 1-3/4" (44.5mm) or 2-1/4" (57mm) Door Thickness

Flushbolt

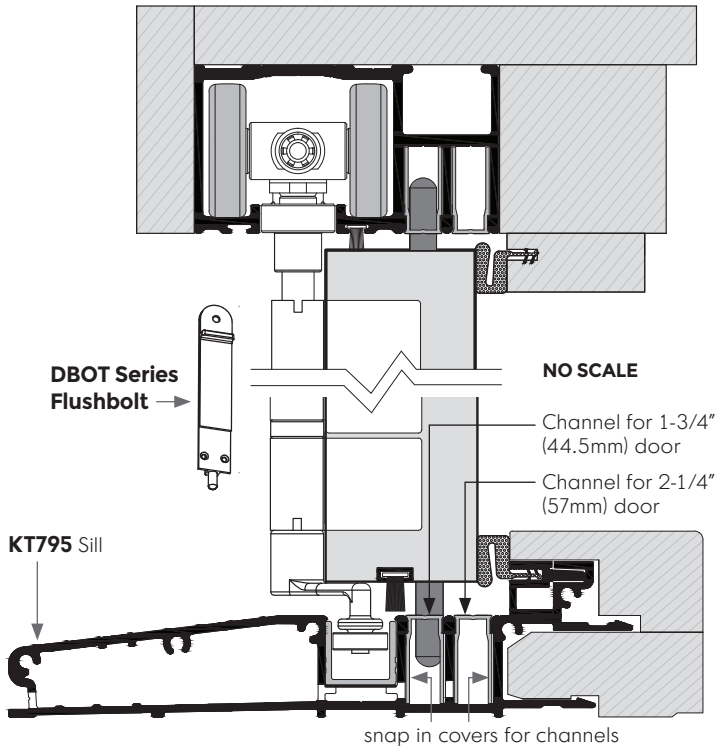

Twinpoint

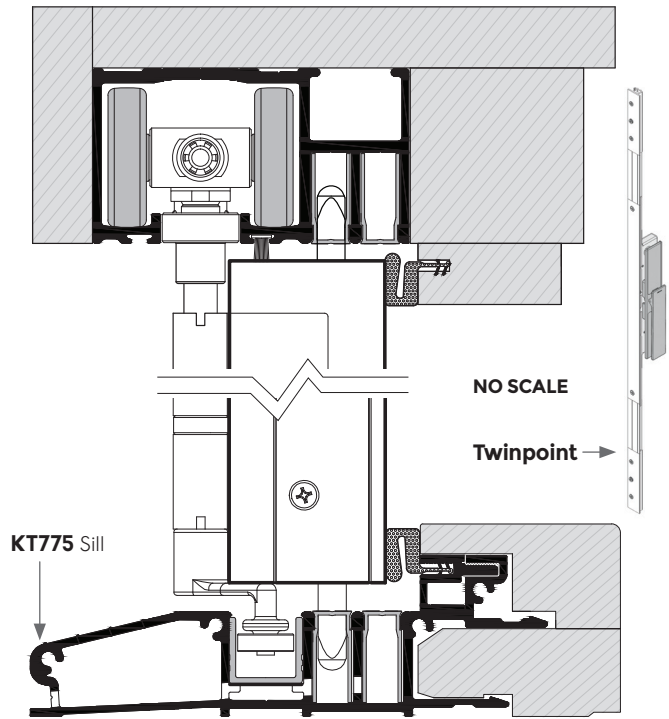

The new DBOT flushbolt & Twinpoint lock were designed to utilize the same channel in any of our four new E3 sills, thus giving you the option to now offer your customer the original flushbolt design or the simple hand rotation of the single handle, driving a 1" throw into the head and sill.

Eclipse Twinpoint Lock & Swing Handle

Specifications

Minimum door thickness: 1-3/8" (35 mm) | Throw length: 1" (25 mm) | Uses: folding, french & sliding

Twinpoint assembly is used in securing each pair of folding panels in the closed position. Not used on the swing (active) panel.

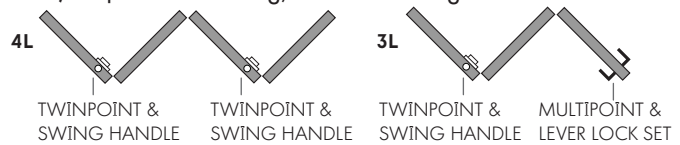

Function

The LT2 operates easily with a simple handle rotation, driving a 1" (25mm) throw into the head and sill. This makes it one of the most secure bolt locks on the market. An installed Twinpoint system is completely accessible and serviceable.

For people with mobility impairments, the Twinpoint offers the security of two flushbolts, but without the access problems associated with flushbolts being too high or low to reach, and hard-to-grip door handles.

Style

LT2 has the sleek and clean styling synonymous with all Eclipse products. Their low profile allows any folding system, such as F3, E2, E3 or E4 to stack neatly, without intrusive door furniture getting in the way. Eclipse Twinpoint locks are fully concealed within the door stile, avoiding long or hard-to-reach dropbolts fixed to the door face, particularly on tall doors. The Eclipse Twinpoint is an unobtrusive, functional and sleek locking solution.

Testing

The Centor LT2 has been tested to 100,000 cycles at maximum configuration to ensure smooth working order beyond their 10 year warranty period. The LT2 Twinpoint locking system has also been exposed to dust, mud, sand and corrosive atmospheres to ensure they stand up to real life use. This includes exposure to salt spray for seaside installations.



NO SCALE

LT2 TwinPoint Lock & DF3 (Aluminum) or DF4 (Stainless Steel) Swing Handles

Kit Components For Twinpoint Assembly



PLEASE NOTE:

When ordering complete TwinPoint Assembly, you are required to order : transmission rod & cover plate, lock/gear box, swing handle & cups.

Twinpoint Lock assembly not available in PVD Brass (TG)

PRODUCT #	DESCRIPTION
EC TwinPoint Lock (LT2 Model) for use with DF3 (Aluminum) & DF4 (Stainless Steel) Models	
ECLT2TRSN0924X	TwinPoint transmission rod, cover plate and strike plate for 96" (2438mm) door height / brushed metallic aluminum finish
ECLT2TRSN0924Y	TwinPoint transmission rod, cover plate and strike plate for 96" (2438mm) door height / black anodized finish
ECLT2TRSN0930X	TwinPoint transmission rod, cover plate and strike plate for 120" (3048mm) door height / brushed metallic aluminum finish
ECLT2TRSN0930Y	TwinPoint transmission rod, cover plate and strike plate for 120" (3048mm) door height / black anodized finish
EC Lock Gear Box for EC TwinPoint (LT2 Model)	
ECLT2NS	Lock/gear box for EC TwinPoint transmission rod, cover plate & handle
EC Swing Handle DF3 (Aluminum) Model For EC TwinPoint (LT2 Model)	
ECDF3SHNAL	DF3 swing handle aluminum, black powder coat
ECDF3SHNAPCN	DF3 swing handle aluminum, satin aluminum powder coat
ECDF3SHNAQ	DF3 swing handle aluminum, bronze powder coat
ECDF3SHNAW	DF3 swing handle aluminum, white powder coat
EC Swing Handle DF4 (Stainless Steel) Model For EC TwinPoint (LT2 Model)	
ECDF4SHNSOL	DF4 swing handle stainless steel, PVD bronze finish
ECDF4SHNSS	DF4 swing handle stainless steel, brushed finish
Cup for Sill or Head (Mandatory for Sill, Optional for Head)	
ECLTBC8SS	Brushed S.S. Finish
ECLTBC8SOL	PVD Bronze Finish
TL2 Router Bit	
ECLT2RB	Router bit for LT2 TwinPoint Lock Assembly
Eclipse E3 Drilling Jig for E3 Hinge placement on door	
KTE3DJ	Eclipse E3 drilling jig for wood doors
Strike Plate for Head (For replacement purposes only) One strike supplied with Twinpoint (Standard)	
ECLTSP8SS	Brushed S.S. Finish
ECLTSP8OL	PVD Bronze Finish



NO SCALE

LT2 TwinPoint

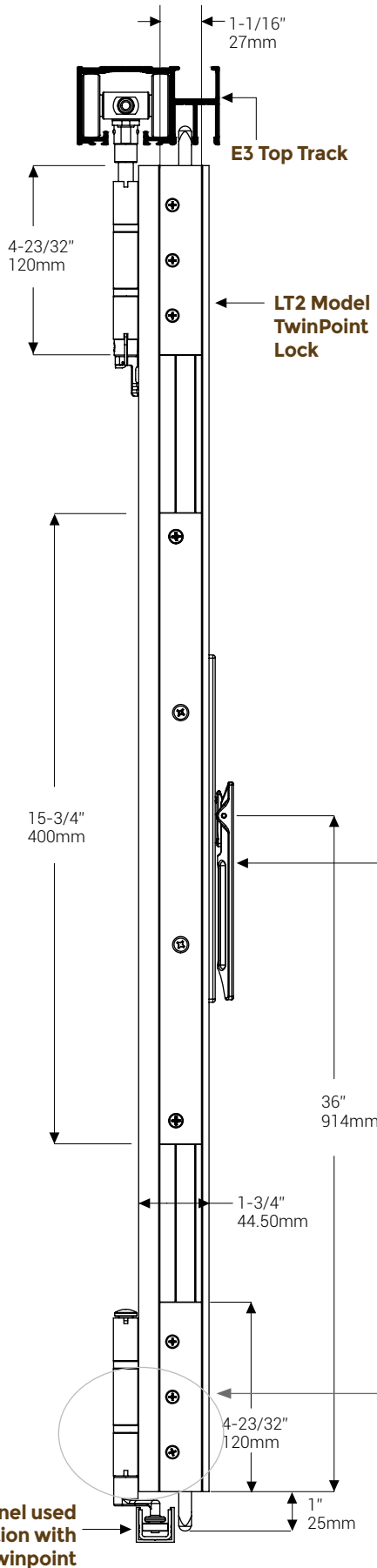

Twinpoint assembly is used in securing each pair of folding panels in the closed position. Not used on the swing (active) panel.

4L

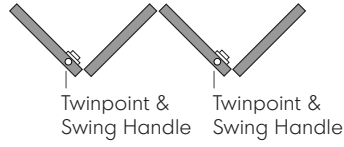

3L



DF3 Model TwinPoint Swing Handle (Aluminum)

or

DF4 Model Twinpoint Swing Handle (Stainless Steel)

New E3 Sill used in conjunction with Twinpoint

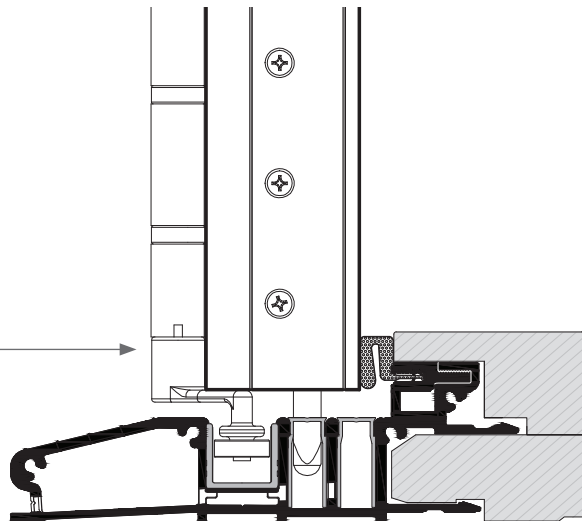

NO SCALE

Wood Stile Route Profile (Outswing Application) For LT2 Model

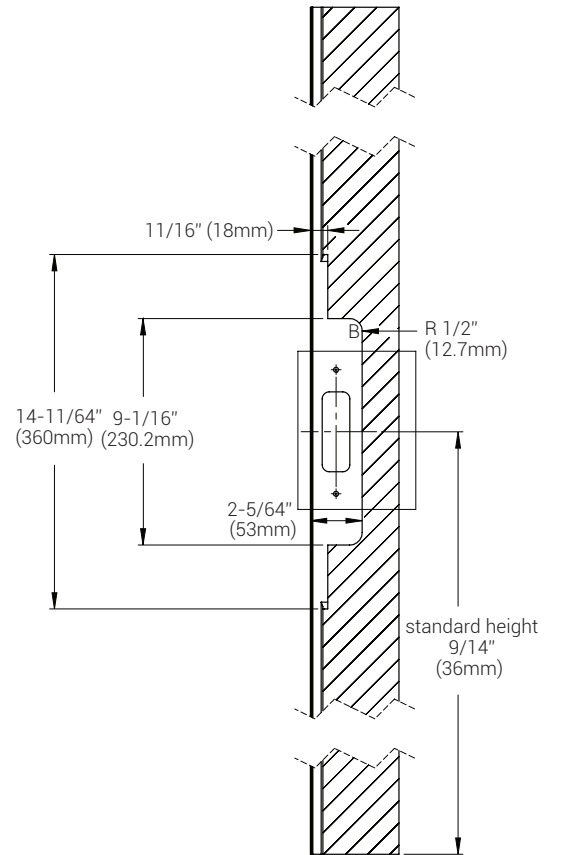
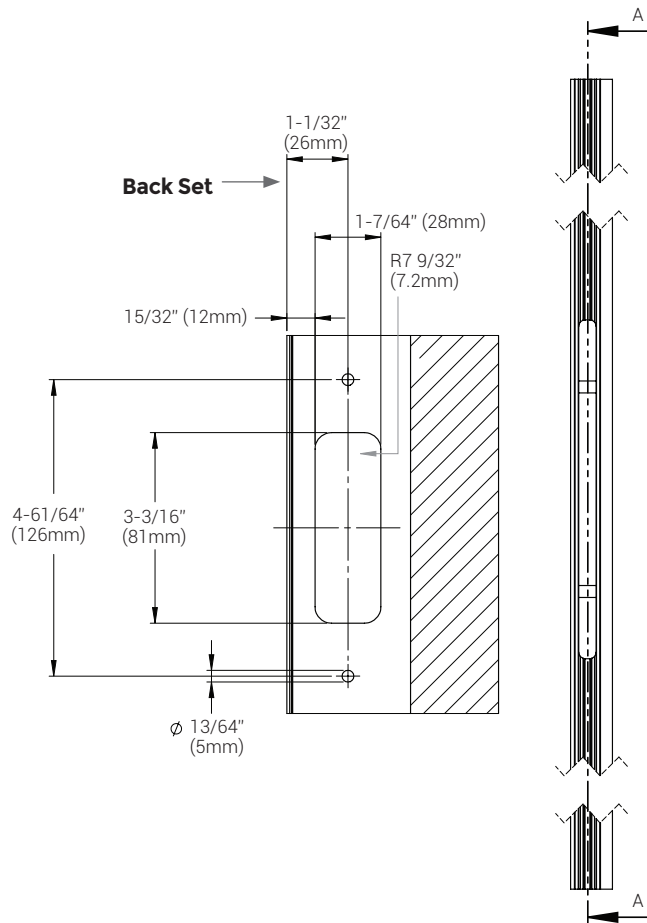
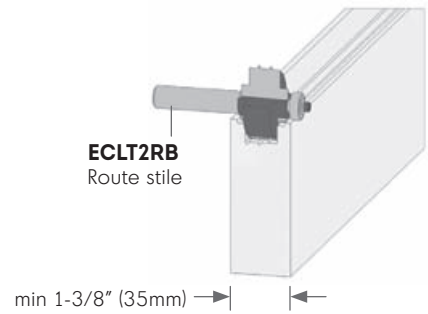
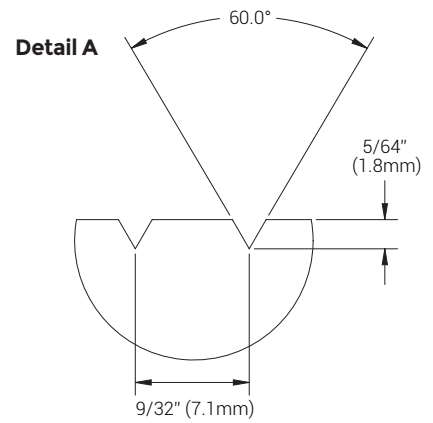
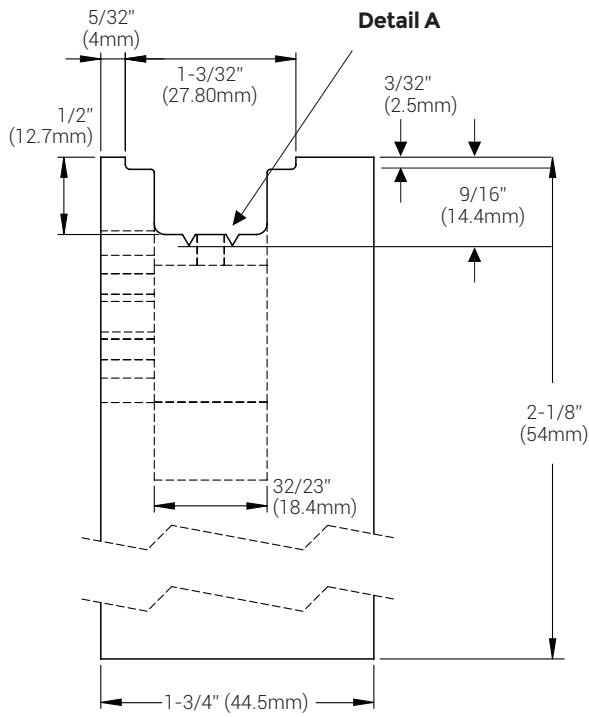

NO SCALE

E2 / E3 Hinge Placement Over TwinPoint

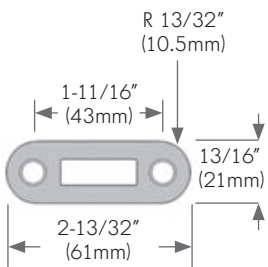
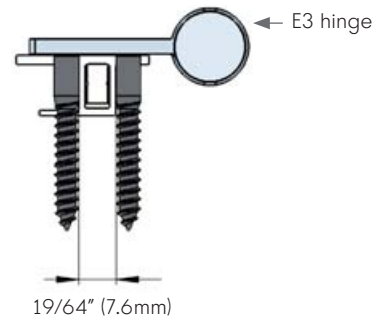
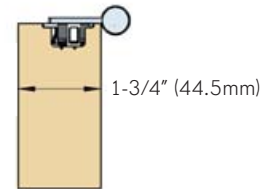
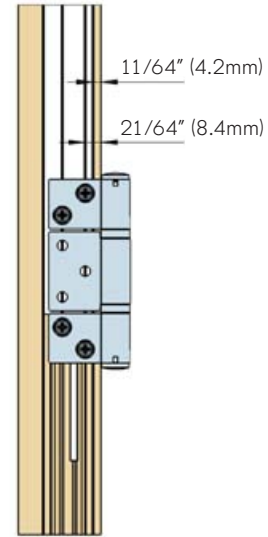
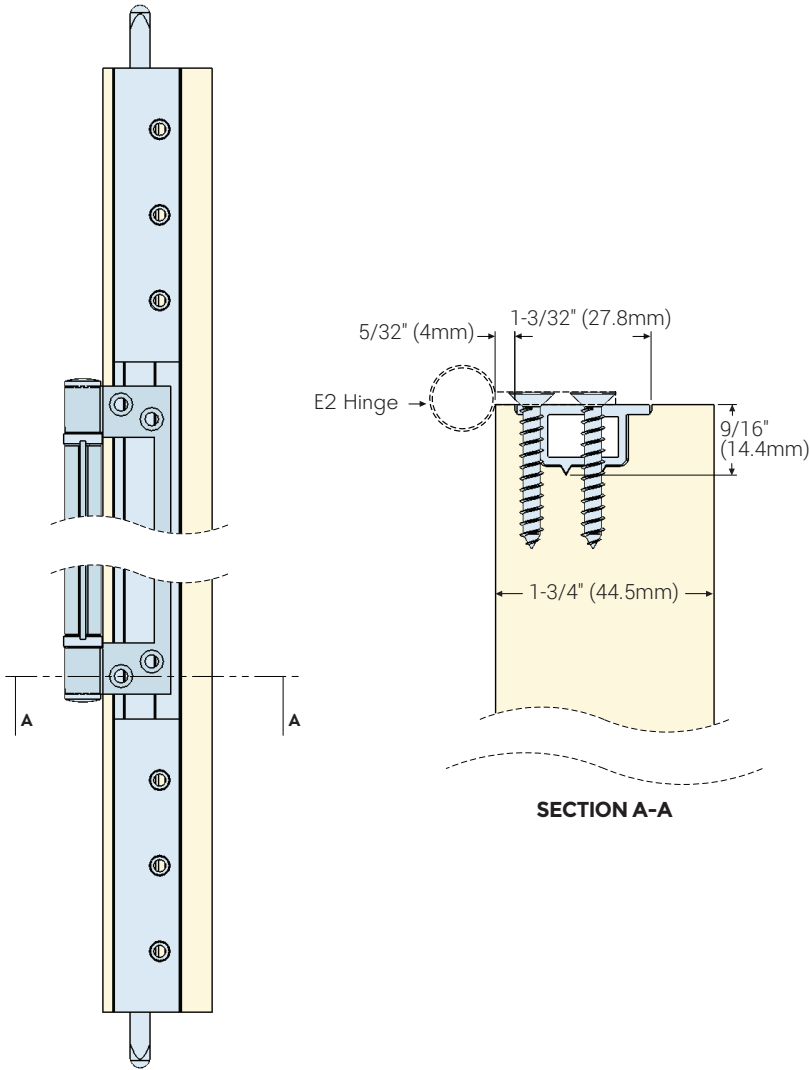

Strike plate for head

ECLTSP8SS Brushed s.s. finish
ECLTSP8OL PVD bronze finish



Flushbolt cup used with floor channel

ECLTBC8SS Brushed s.s. finish
ECLTBC8SOL PVD bronze finish

NO SCALE

DF3 TwinPoint Swing Handle, Choice of 4 Finishes Over Cast Aluminum

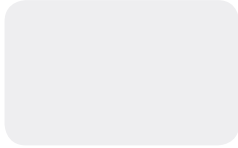

White Powder Coat



Satin Aluminum Powder Coat

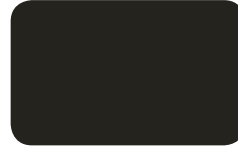

Black Powder Coat

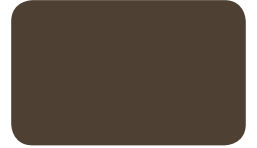

Bronze Powder Coat

LT2 TwinPoint Housing Cover Plate Finishes

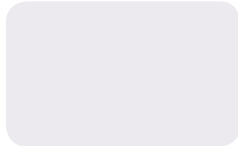

Brushed Metallic Aluminum



Black Anodized Aluminum

PLEASE NOTE: For technical reasons associated with color reproduction, the colors shown on this brochure give only an indication of color & finish. No warranty or guarantee can be given that they will exactly match the product as supplied.

DF4 Twinpoint Swing Handle (SS), Choice of 2 Finishes



Brushed stainless steel

PVD bronze over stainless steel

Finishes & Materials

The Twinpoint door furniture is available in a range of finishes to suit any door or décor.

Twinpoint Lock assembly not available in PVD Brass (TG)



LT2 Model Twinpoint

LT2 Transmission Housing
Brushed Metallic Aluminum or
Black Anodized finish

Swing Handle

DF3 : Aluminum handle (4 finishes)
DF4 : Stainless Steel Handle (2 finishes)

Twinpoint assembly is used in securing each pair of folding panels in the closed position. Not used on the swing (active) panel.

4L

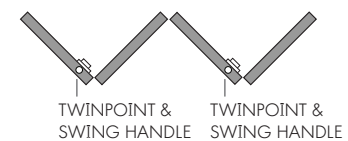

3L

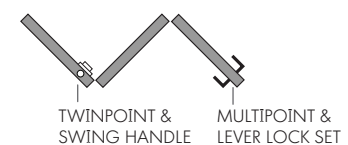

NO SCALE

Jamb To Sill Assembly

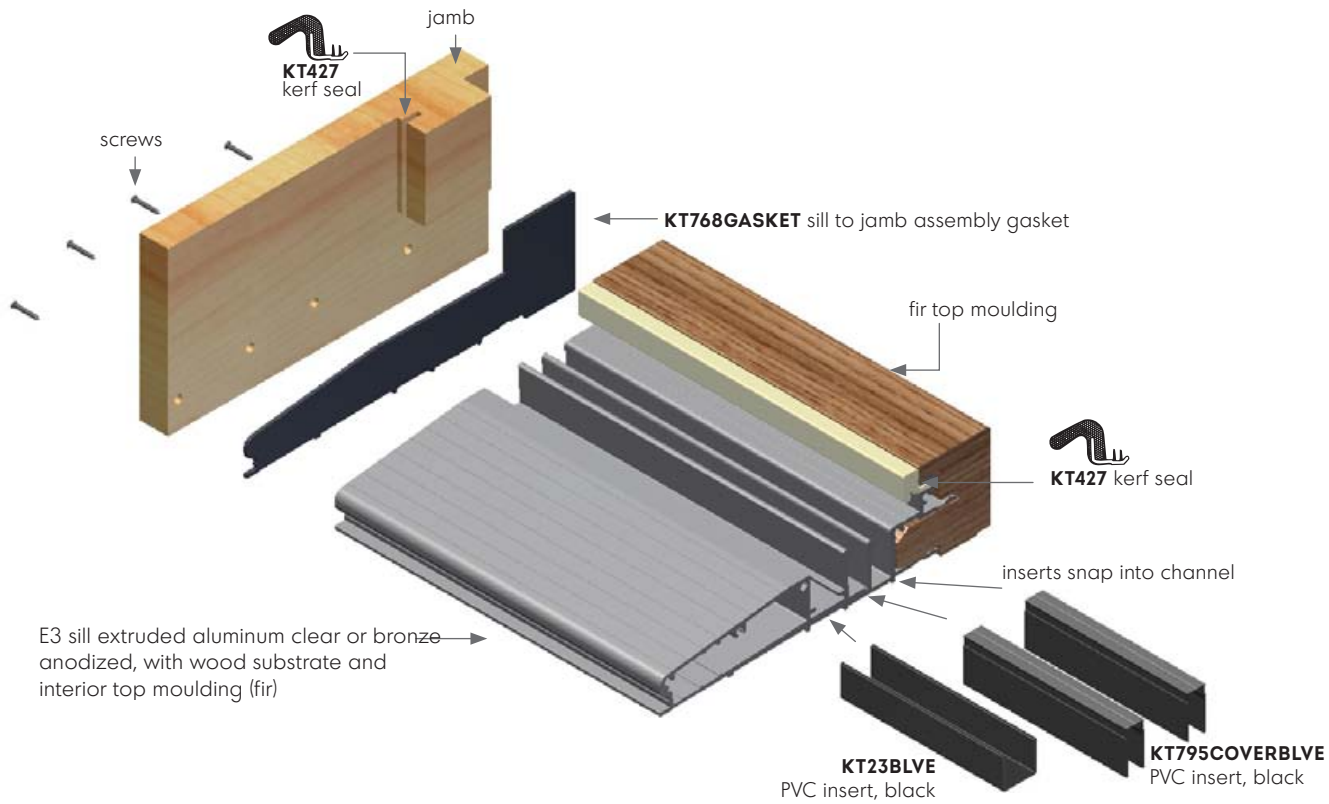

KT23 Optional Floor Channel Application For Outswing Or Inswing Doors

This application is recommended for interior application, exterior non-rainfall weather conditions or undercover well protected doors.

2-1/4" (57mm) door, outswing application shown. Other door thickness may be used.

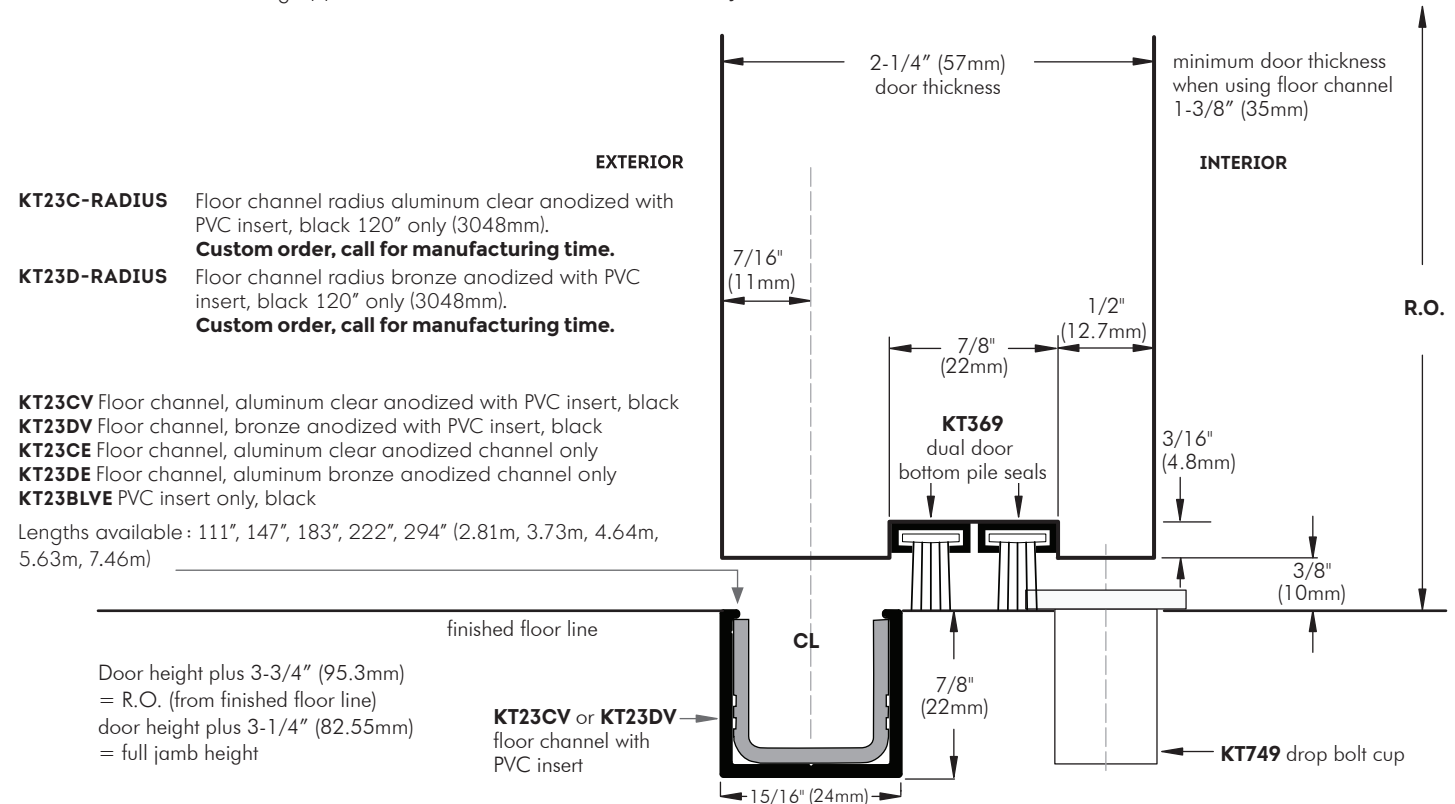

FULL SCALE EXCEPT AS NOTED

KT190C Wood Astragal Detail For Eclipse E3 Interior Folding System

Triple Seal For Superior Sealing Performance

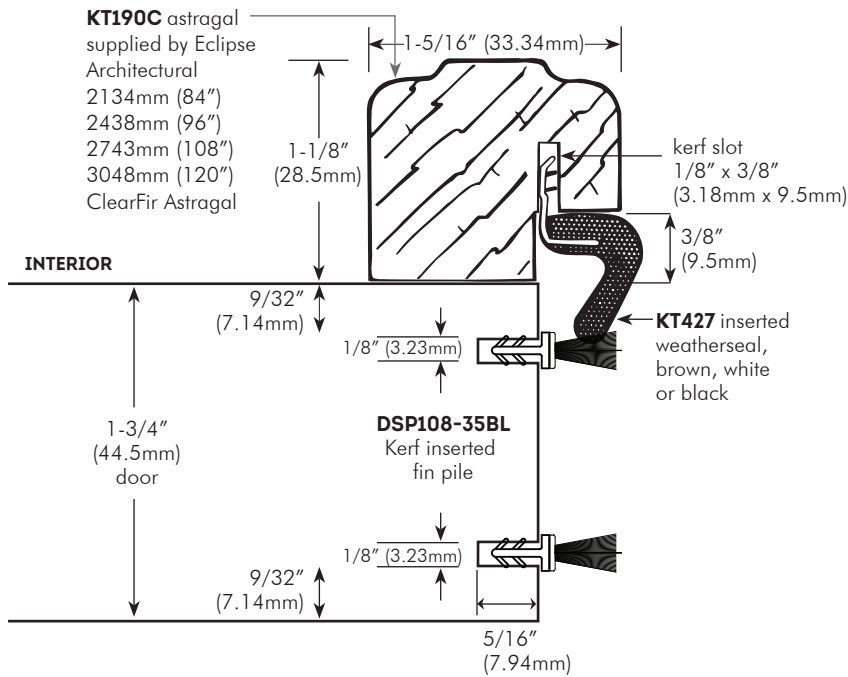

NOTE: For ease of mounting all hardware, it is recommended to use square edge doors.

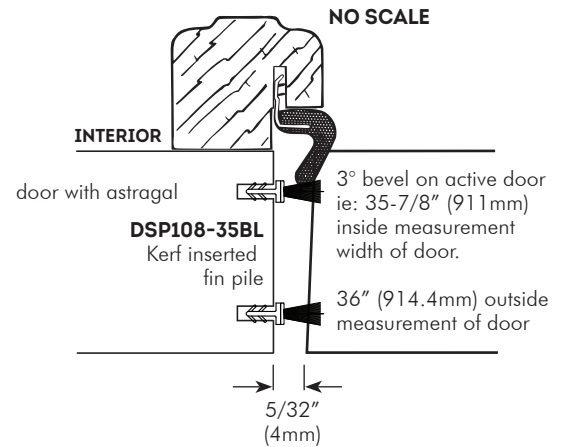

Surelock Adjustment™

Surelock™ is the trademark for Centor's carrier pin locking system (patents granted). Carrier pins at the top pivots, intermediate and end carriers support the full door weight and it is here that the height of the panels is adjusted. Surelock™ ensures that once the heights are set, they stay set.

Using Surelock™ is simple:

1. Surelock™ is supplied with a plastic shipping clip installed to make initial adjustment very easy.
2. Insert a flathead screwdriver into the slot to rotate the pin.
3. When correct adjustment is reached and doors operate well, remove the shipping clip (it's seriously ugly to help you remember).
4. Surelock™ will automatically snap into place when the blade and slot are aligned.
5. To readjust at a later date, simply pull the blade down to disengage it from the slot and rotate the pin.

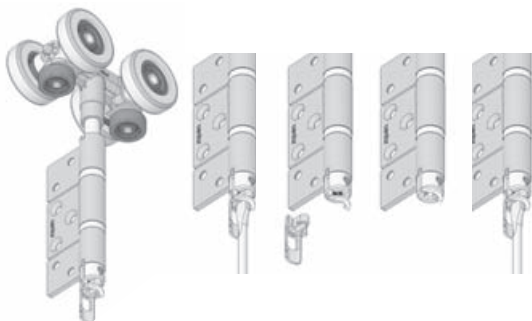

Latching Door Hold (DH)

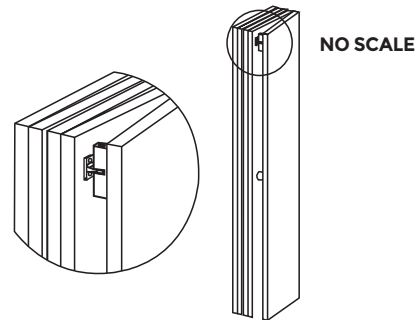

- KT740DHC Clear anodized
- KT740DHD Bronze anodized
- KT740DHBL Black powder coat
- KT740DHW White powder coat

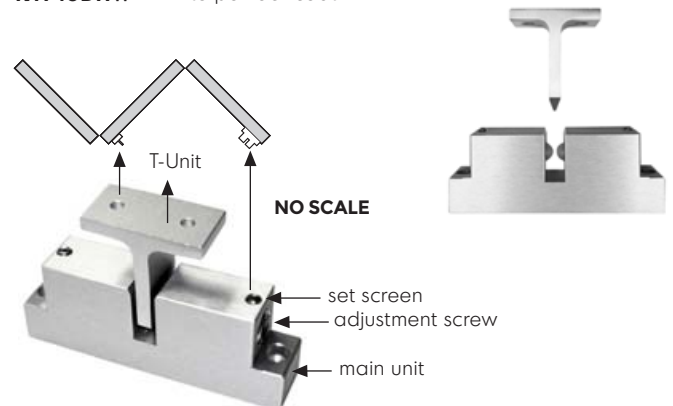

FULL SCALE EXCEPT AS NOTED

E3 Hardware Placement

(4L) Outswing Application

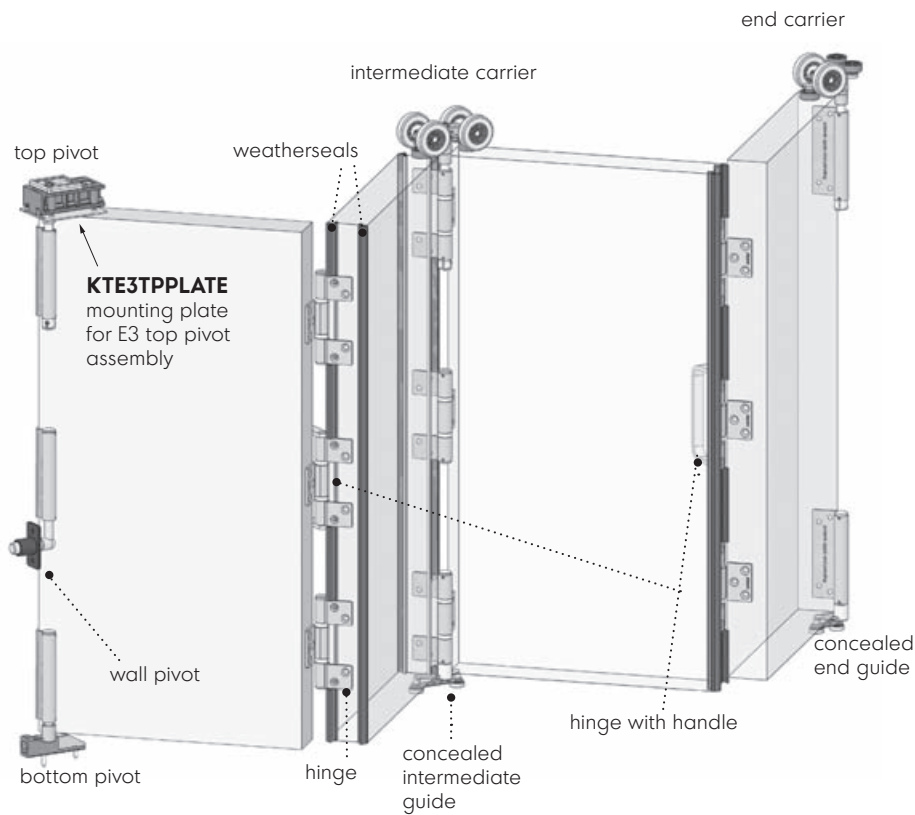

C3 Door Hold Magnets

(OPTIONAL)



KTDCAS Satin Aluminum Finish
KTDCAOL Black Finish

Interior Applications: How To Determine Swing Of Systems

The following is a guideline when determining outswing or inswing applications for the purpose of choosing correct hardware and flushbolts.

NOTE: The interior/exterior designation (i.e. 3L) is still used for interior application because it just makes it easier to understand.

FOR EXAMPLE:

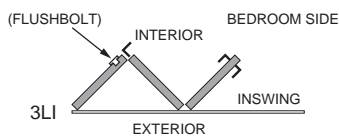

Hall Or Living Room

The above example (3LI) shows the system swinging into the bedroom and flushbolts on the same side. This would be an inswing system and the bedroom side is considered the interior side. Passage set only recommended for the swing door.

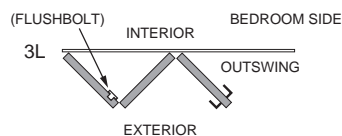

Another Room

The above example (3L) shows the system swinging into another room and flushbolts on the bedroom side. This would be an outswing system and the bedroom side is considered the interior side. Passage set only recommended for the swing door.

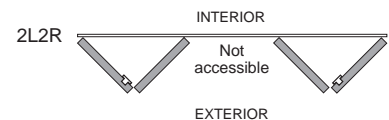

The above example (2L2R) is not recommended for interior applications because of the potential of getting locked in a room without any exit. Other configurations not recommended. 2L, 2R, 4L, 4R, 6L, 6R, 8L, 8R; basically pairs or even number or door panels.

NO SCALE

Magnets

KTEMAG Magnets for holding the door panels in the open position

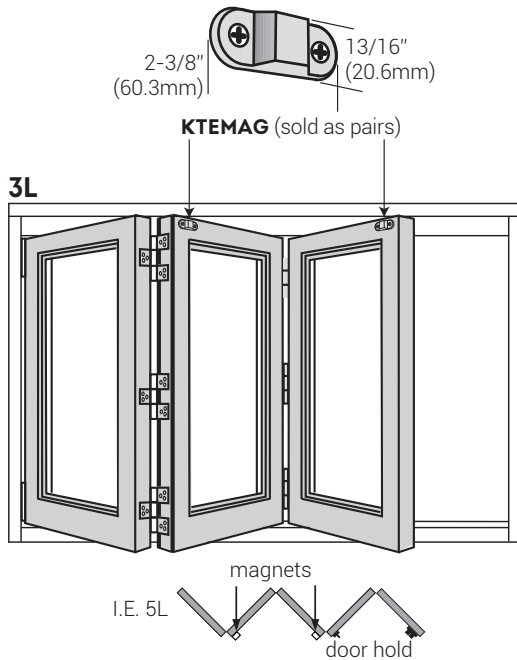

Flushbolt Placement

Suggested flushbolt lengths for door heights 80" to 118" (2032mm to 2997mm)

NOTE : End user may require longer flushbolts for top of doors for easier reach. When using E2 hardware for folding windows, top flushbolt length must be specified.

Scale : 1/4" = 1ft.

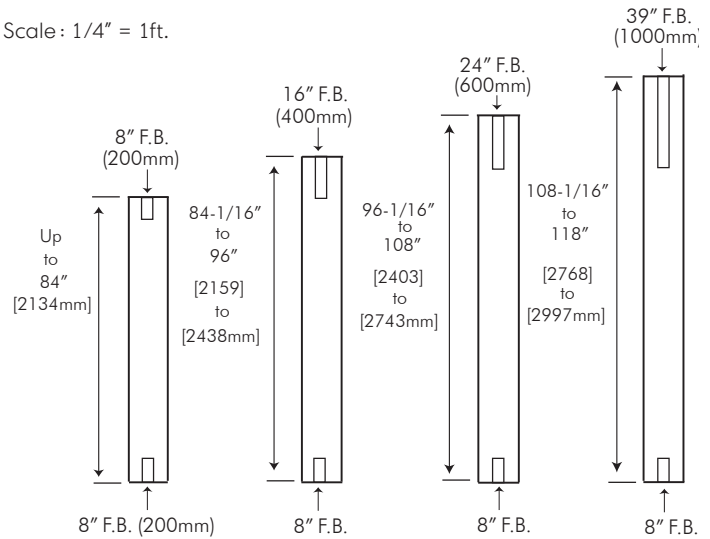

Manual Door Calc

Clearances

Pivot door to jamb 9/32" (7mm)
 Swing door to jamb 9/32" (7mm)
 Panel to panel gap 5/32" (4mm)
 Bottom of door panel to sill 3/8" (9.5mm)
 Top of door panel to header 3/16" (5mm)
 Inside face of door panel to stop 3/8" (9.5 mm)

Rough opening specs for E3

1. Door Height plus 5" (127mm) = R.O. when using inswing or outswing E3 Sills and Frame specs.
2. Door Height plus 4-1/4" (107.9mm) = R.O. when using KT788E3 ADA Sill.
3. Door Height plus 3-3/4" (95.25mm) = R.O. when using E3 floor channel.

Manual calculation for determining R.O. (i.e. configuration 1L3 R, i.e. door panel size 36" x 84" [914mm x 2134mm])

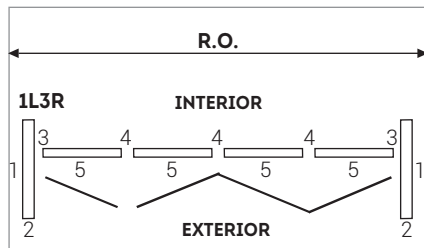

WIDTH

- 1) Jamb to Stud - typical 1/4" (6mm) shimming x 2 = .5" (12mm)
 - 2) Jamb thickness 11/16" (17.5mm) x 2 = 1.375" (34.9mm)
 - 3) Panel to Jamb - Clearance 9/32" (7mm) x 2 = .5624" (14mm)
 - 4) Panel to Panel - Gap 5/32" (4mm) x 3 = .4686" (12mm)
 - 5) Panel width 36" (914) x 4 = 144" (3656mm)
- R.O. (width) 146-29/32" or 146.906" or (3731mm) or (3.73m)

For O.S.M. width of unit take R.O. minus 1/2" (12mm) i.e. 146-29/32" (3731mm) - 1/2" (12mm) = 146-13/32" (3718mm).

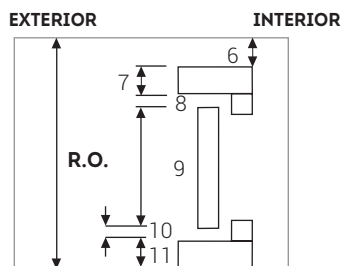

HEIGHT

- 6) Frame header to R.O. header. Typical 1/2" (12mm) shimming x 1 = .5" (12mm)
- 7) Frame header 2-21/32" (68mm) x 1 = 2.677" (68mm)
- 8) Top of door panel to frame header 3/16" (5mm) x 1 = .1875" (5mm)
- 9) Door panel height 84" (2134mm) x 1 = 84" (2134mm)
- 10) Bottom of door panel to top of sill 13/32" (10mm) x 1 = .3937" (10mm)
- 11) Sill height 1-3/16" (30.16mm) x 1 = 1.1875 (30.16mm)

R.O. Height 88 15/16" or 88.95" or (2259 mm) or (2.25m)

For O.S.M. height of unit take R.O. minus 1/2" (12mm). i.e. 88-15/16" (2259mm) minus 1/2" (12mm) = 88-7/16" (2246mm).

NO SCALE

E3 Parts Selection

When ordering, add color designation (letters) to end of product number :

OL: pvd bronze | **S:** stainless steel | **TG:** pvd brass * ***PVD brass finish (TG) is custom order, call for manufacturing time.**

KTE3CPS
Pivot sets
2 pieces



KTE3CBPIVOTH bottom pivot housing only (replacement part)

KTE3WPS
Wall pivot set, jamb mounted middle pivot for doors over 88" (2235mm)
1 piece

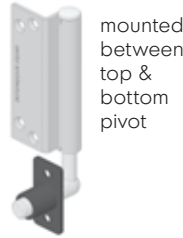

mounted between top & bottom pivot

KTE3WPCUPS cup only for middle pivot, brushed stainless steel
KTE3WPCUPQ cup only for middle pivot, bronze powder coat

KTE3CLCS
Left carrier sets
2 pieces



concealed bottom guide

KTE3CRCS
Right carrier sets
2 pieces



concealed bottom guide

KTE3CICS
Intermediate carrier sets, 3 pieces



concealed bottom guide

KTE3EH
Interior D pull handle for inswing doors
1 piece



KTE3HS
Hinge sets (FLAT) with middle handle for outswing doors
3 pieces



KTE3HNHS
Hinge sets (FLAT) without middle handle for inswing doors
3 pieces



KTE3HHS
Half OFFSET hinge sets with middle handle for outswing doors
3 pieces



KTE3HHNS
Half offset hinge sets without middle handle for inswing doors
3 pieces



Intermediate carrier sets with additional hinge

KTE3HNNH Single hinge, order separately

concealed bottom guide

Hinge sets with handle for outswing doors



KTE3H Single hinge, order separately

Hinge sets no handle for inswing doors



KTE3HNNH Single hinge, order separately

Half offset hinge sets with handle for outswing doors



KTE3HH Single hinge, order separately

Half offset hinge sets no handle for inswing doors



KTE3HHNNH Single hinge, order separately

NO SCALE

E3 Parts Selection

* PVD brass (TG) finish is custom order, call for manufacturing time.

Pivot Set



- 2 PIECES**
- KTE3CPSTG** PVD brass *
- KTE3CPSOL** PVD bronze
- KTE3CPSS** stainless steel

Wall Pivot Set

Use with above pivot set on doors over 8ft (2438mm) in height



- 1 PIECE**
- KTE3WPSTG** PVD brass *
- KTE3WPSOL** PVD bronze
- KTE3WPSS** stainless steel

Half Offset Hinge Set

Middle hinge with handle for outswing doors



- 3 PIECES**
- KTE3HHSTG** PVD brass *
- KTE3HHSOL** PVD bronze
- KTE3HHSS** stainless steel

Hinge Set (Flat)

Middle hinge with handle for outswing doors



- 3 PIECES**
- KTE3HSTG** PVD brass *
- KTE3HSOL** PVD bronze
- KTE3HSS** stainless steel

Intermediate Carrier Set



- 3 PIECES**
- KTE3CICSTG** PVD brass *
- KTE3CICSOL** PVD bronze
- KTE3CICSS** stainless steel

Right Carrier Set



- 2 PIECES**
- KTE3CRCSTG** PVD brass *
- KTE3CRCSOL** PVD bronze
- KTE3CRCSS** stainless steel

Left Carrier Set



- 2 PIECES**
- KTE3CLCSTG** PVD brass *
- KTE3CLCSOL** PVD bronze
- KTE3CLCSOL** stainless steel

Replacement Screws for all hinges

- KTE3SCREWTG** PVD brass *
- KTE3SCREWOL** PVD bronze
- KTSCREWSS** stainless steel

Number of Hinges for Panel Heights of 80" to 118" (2032mm to 2997mm)

Intermediate carrier sets



Up to 96" (2438mm) door height use 1, 3, 5

96-1/16" to 108" (2440 to 2743mm) use 1, 2, 3, 5

108-1/16" to 118" (2745 to 2997mm) use 1, 2, 3, 4, 5

Hinge set or half offset hinge set



Up to 96" (2438mm) door height use 1, 3, 5

96-1/16" to 108" (2440 to 2743mm) use 1, 2, 3, 5

108-1/16" to 118" (2745 to 2997mm) use 1, 2, 3, 4, 5

Pivot set top & bottom



Up to 87-15/16" (2234mm) door height use 1 & 5

88" to 96" (2235 to 2438mm) door height use 1, 3, 5

96-1/16" to 108" (2440 to 2743mm) door height use 1, 2, 3, 5

108-1/16" to 118" (2745 to 2997mm) door height use 1, 2, 3, 4, 5

Single Hinge Half Offset

No handle for inswing doors. Use as 4th & 5th hinge for doors over 8ft (2438mm) in height.



- 1 PIECE**
- KTE3HHNHTG** PVD brass *
- KTE3HHNHOL** PVD bronze
- KTE3HHNHS** stainless steel

Hinge Set (Flat)

No middle handle for inswing doors



- 3 PIECES**
- KTE3HHNHTG** PVD brass *
- KTE3HHNSOL** PVD bronze
- KTE3HHNHS** stainless steel

Single Hinge (Flat)

No handle for inswing doors. Use as 4th & 5th hinge for doors over 8ft (2438mm) in height.



- 1 PIECE**
- KTE3HNHTG** PVD brass *
- KTE3HNHTG** PVD bronze
- KTE3HNHTG** stainless steel

Single Hinge Half Offset

With handle for outswing doors. Use as 4th & 5th hinge for doors over 8ft (2438mm) in height



- 1 PIECE**
- KTE3HHTG** PVD brass *
- KTE3HHOL** PVD bronze
- KTE3HHS** stainless steel

Half Offset Hinge Set

No middle handle for inswing doors



- 3 PIECES**
- KTE3HHNHSTG** PVD brass *
- KTE3HHNHSSOL** PVD bronze
- KTE3HHNHSS** stainless steel

Single Hinge (Flat)

With handle for outswing doors. Use as 4th & 5th hinge for doors over 8ft (2438mm) in height



- 1 PIECE**
- KTE3HTG** PVD brass *
- KTE3HOL** PVD bronze
- KTE3HS** stainless steel

NO SCALE

Top 6 Cool Custom Features Of The MK2 DSD Multi-Point Door Locks

- » 3 and 4 hook models
- » Adjustable Stainless Steel strikers
- » 45mm back set centre cases
- » Single and double door locks
- » 6'8" (2032mm) and 8' (2438mm) product models
- » Easy modification for custom door heights
- » Compliant to DP100 hurricane testing (Dade County)
- » Compatible with North American key-way and Euro-cylinder applications
- » Complementary range of Lever Lock Sets in a choice of finishes
- » 10 year mechanical breakdown guarantee on all MK2 Multi-point products
- » 10 year surface finish guarantee on all PVD finish/Brass Lever Lock Sets
- » Fasteners for attaching Multi-point to Door Stile are included.

EC3MPSCREW (#8 x 32 x 1-1/2" SS).

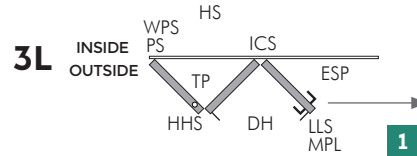

6

1

3

2

5

4

1

6



1 High Security Hooks 304 SS

Ensuring even distribution of weatherproofing and strength



4 Opposing Centre Hook 304 SS

Optimizes anti-separation security



2 Quick Change Reversible Latch 304 SS

Fast and simple handing for Lockmaster



5 Anti-slam Mechanism

Prevents accidental operation of the lock when open



3 Grade 304 Stainless Steel Faceplate

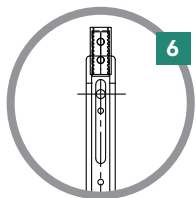

6 Shootbolt Extensions

Delivering enhanced performance

This photo portrays a short sample lock made for promotional purposes only.

NO SCALE

C3 Lever Lock Sets

C3 Ferraro-2 Series: Lever Lock Sets, 4 finishes available

Ferraro back plate 30mm active or inactive sets



White Powder Coat
DSPF1341-03W (active)
DSPF1342-03W (inactive)



Satin Powder Coat
DSPF1341-87SC (active)
DSPF1342-87SC (inactive)



Black Powder Coat
DSPF1341-06BL (active)
DSPF1342-06BL (inactive)



Bronze Powder Coat
DSPF1341-79BR (active)
DSPF1342-79BR (inactive)

Florence Series

(Scrolled)



Satin Nickel
DSPF1111-78 (active)
DSPF1112-78 (inactive)

Bronze Powder Coat
DSPF1111-79 (active)
DSPF1112-79 (inactive)

Brass
DSPF1111-32 (active)
DSPF1112-32 (inactive)



Antique Brass
DSPF1111-80 (active)
DSPF1112-80 (inactive)



Antique Nickel
DSPF1111-88 (active)
DSPF1112-88 (inactive)

back plate 44mm active or inactive sets

Faenza Series

(Swept)



Satin Nickel
DSPF1221-78 (active)
DSPF1222-78 (inactive)

Brass
DSPF1111-32 (active)
DSPF1112-32 (inactive)

Bronze Powder Coat
DSPF1221-79 (active)
DSPF1222-79 (inactive)



Antique Brass
DSPF1221-80 (active)
DSPF1222-80 (inactive)



Antique Nickel
DSPF1221-88 (active)
DSPF1222-88 (inactive)

back plate 30mm active or inactive sets

PLEASE NOTE: For technical reasons associated with color reproduction, the colors shown on this brochure give only an indication of color & finish. No warranty or guarantee can be given that they will exactly match the product as supplied.

NO SCALE



DSGroup®

www.theDSgroup.com

Tomorrow's Innovative Solutions for Today's Doors & Windows

The DS Group Of Companies : Draftseal®, Kristrack®, Eclipse Architectural® & DSD Hardware

Head Office & Manufacturing Centre, Vancouver, Canada

7470 Buller Avenue, Burnaby, B.C. V5J 4S5 Canada

Phone: (604) 451-1080 • Fax: (604) 451-1140 • info@theDSgroup.com

Outside Vancouver, B.C., please use our toll free numbers : Phone: 1-888-520-9009 Fax: 1-800-567-2887

Branch Office & Manufacturing Centre, Toronto, Canada

Phone head office toll free 1-888-520-9009 for branch address

Branch Office & Distribution Centre, Los Angeles, California

Phone head office toll free 1-888-520-9009 for branch address

Eclipse Architectural® Corporate Showrooms

Vancouver & Toronto, Canada • Los Angeles, California, USA

THE DS GROUP IS THE BRAND IMAGE OF A.K. DRAFT SEAL LTD.