

DISCLAIMER: These technical drawings are provided solely for informational purposes. Functional Fenestration, Inc. does not warrant that these drawings satisfy federal, state or local laws, regulations or ordinances which may apply in the jurisdiction in which the product supplied is used. Customer accepts full responsibility for compliance with all legal and regulatory requirements pertaining to the installation and use of window/door/skylight hardware.

Description	Qty.	Material	Item #
Carriage	1	316 Stainless Steel	K310 61

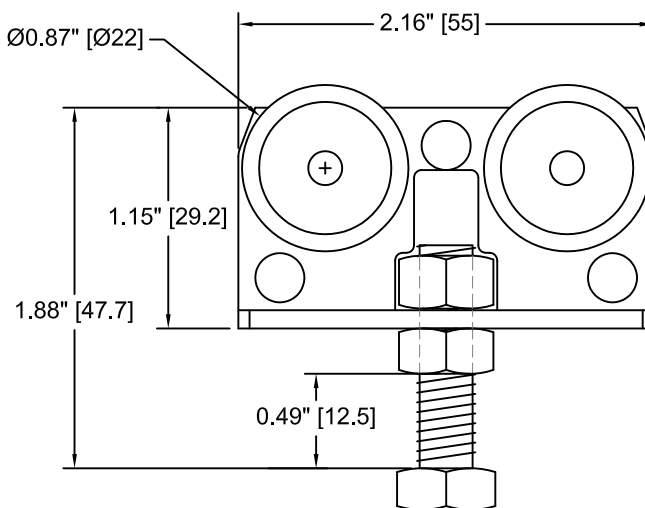
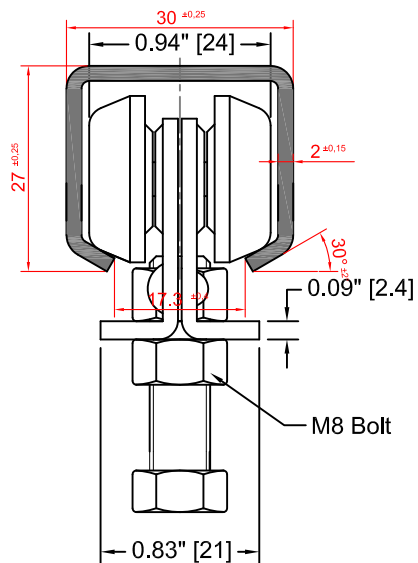
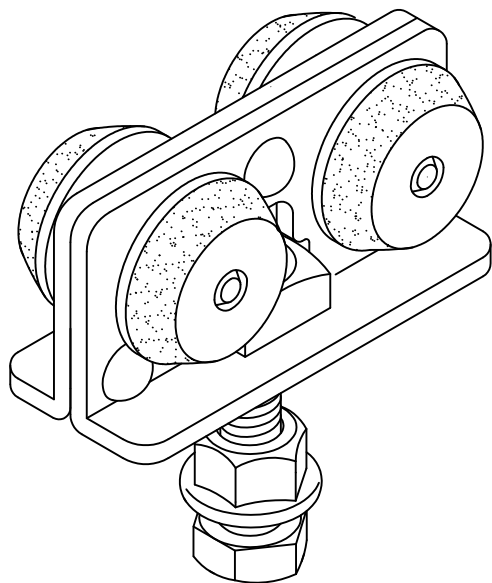

CARRYING CAPACITY PER DOOR LEAF

REDUCED STANDARD LOAD	132 LB.
STANDARD LOAD	165 LB.
MAXIMUM LOAD	165 LB.

REDUCED STANDARD LOAD: ELECTRICAL POWERED DOORS (CONSTANT USE)
 STANDARD LOAD: HAND MOVED DOORS OR GATES OFTEN USED.
 MAXIMUM LOAD: SELDOM USED DOORS AND GATES.

ALL MEASUREMENTS IN INCHES AND MILLIMETERS



TITLE:
 TIGER SLIDING SYSTEMS 300
 K310 61 Carriage

DATE: 05.16.05
 DRAWN BY: JDG
 SCALE: 1:1

DWG #: 300-2
 SHEET: 1 of 1
 REV: A

GENERAL TOLERANCES
 DECIMAL X.XX ± 0.05
 DECIMAL X.X ± 0.10
 ANGULAR X ± 1°

